



A QUALITY YOU TRUST



*KP*

OMEGA

4 Borg ElMohandsin, Rabaa ElAdawia, Nasr City, Cairo, Egypt  
Tel: (+202) 226 05695 - 240 51884 | Fax: (+202) 22629718

Factory: Block 71, Sixth industrial Area, Badr City.  
info@neiscoegypt.com | www.neiscoegypt.com

# INDEX



- UPVC Pressure Fittings .....	1
- UPVC Valves .....	24
- Butterfly Valves .....	37
- PP Compression Fittings .....	43
- PP Clamp Saddles .....	50
- In Line & On Line Drippers .....	55

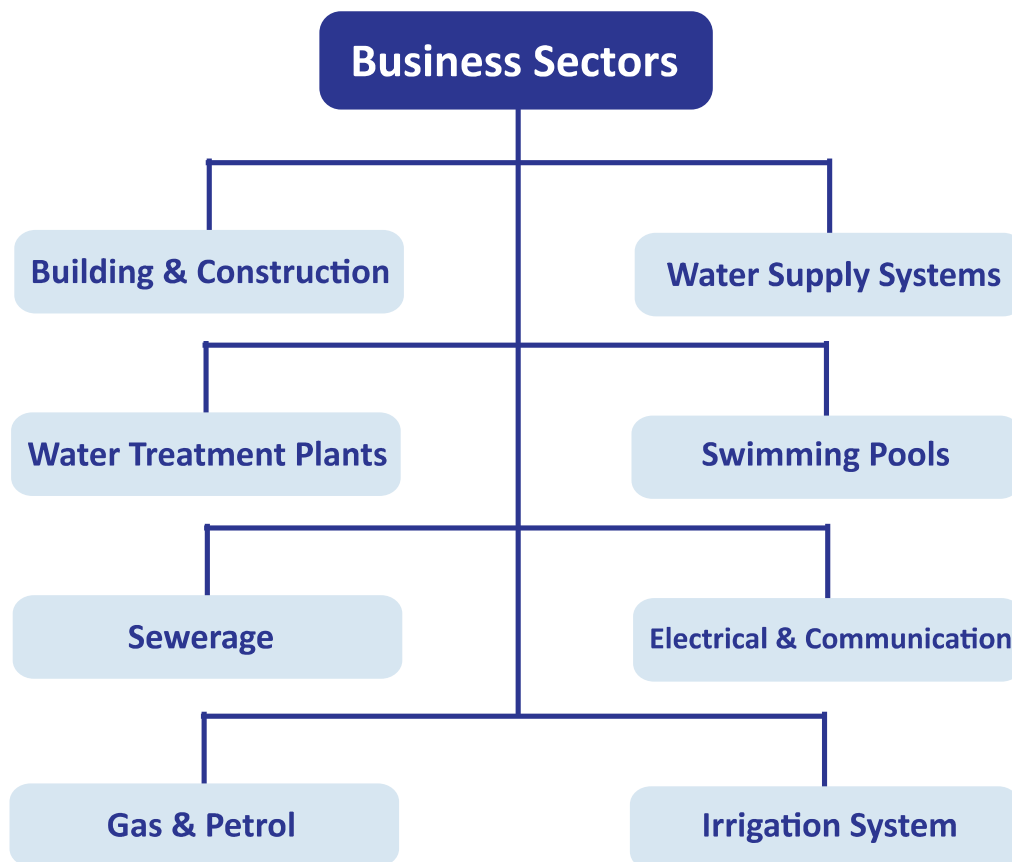

**Neisco For Modern Water Systems Production is an Egyptian company with a 30 year legacy in the field of piping systems. Since Neisco was brought to life, it has pioneered its industry knowledge to become the bench mark in the market.**

**Located in Badr Industrial City, Neisco has 4 factories working around the clock to ensure maximum productivity and efficiency. With a product range that exceeds 3000 items, Neisco can fulfill product needs in all sectors.**

**Neisco is considered a leading manufacturer in the field of UPVC pressure fittings, Sewer fittings, Valves, PP compression fittings, Drip Irrigation tubes, as well as UPVC & PE pipes. Sold in Egypt and worldwide, Neisco exports its products across 4 continents including Europe, Africa and the Middle East, serving 40+ clients located in more than 20 countries.**

**In order to meet our customers' increasing demands, Neisco has evolved its production capacity to reach up to 3000+ tons of fittings, and 9000+ tons of pipes, with ambitious plans to increase our product capacity to serve the increasing demand of our customers.**

**Our success story wouldn't be possible without the mutual work with over 180+ partners, joint-ventures, distributors & agents.**

**Neisco is proud to be classified among top European producers of PVC, providing world-class quality of full range systems, by implementing international standards ISO 727 DIN 8063, EN 1452 AND ISO 4421/3.**

**Neisco holds excellence and quality certificates that grant its customers a competitive edge.**

**This is achieved by applying strict quality control measures throughout the whole operational cycle.**

**Neisco guarantees that all client orders are delivered in a timely manner, with consistent tracking and follow up. Neisco aims to exponentially grow and expand across domestic and international markets while maintaining its product quality and satisfactory sale and after-sale services.**

# **A QUALITY YOU TRUST**

# NEISCO Product Category; UPVC Fittings

★ Elbow 90°



MM (20 up to 400)  
TH (1/2" up to 4")  
BS (1/2" up to 8")

★ Tee 90°



MM (20 up to 355)  
TH (1/2" up to 4")  
BS (1/2" up to 8")

Elbow 45°



MM (20 up to 400)  
TH (1/2" up to 4")  
BS (1/2" up to 8")

★ Union with O-Ring



MM (20 up to 110)  
TH (1/2" up to 4")  
BS (1/2" up to 4")

★ Socket

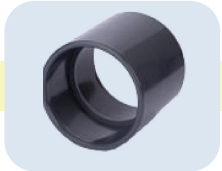

MM (20 up to 400)  
TH (1/2" up to 4")  
BS (1/2" up to 10")

Cap



MM (20 up to 250)  
TH (1/2" up to 4")  
BS (1/2" up to 8")

Male Adaptor



TH (20x25x1/2"  
up to 110x125x5")

★ 90° Tee Reduced



MM (25x20 up to 200x110)  
BS (1.1/4" up to 4x3")

★ Reducing Bush



MM (25x20 up to 400x355)  
BS (3/4x1/2" up to 8x6")

Blank Flange



MM (20 up to 225)

Stub Serrated



MM (25 up to 400)  
BS (1/2" up to 10")

Loose Flange



MM (25 up to 400)

Reducing Socket



MM (20x16 up to 225x160)  
BS (3/4x1/2" up to 4x3")

Reducing piece M/F



MM (25x32x20  
up to 140x160x125)

Reducer M/F



TH (3/4" up to 1/2")

Nipple Threaded



TH (1/2" up to 4")

Saddle



MMxInch (75x3/4"  
up to 225x3")

★ Available in Plain / Threaded



## NEISCO Product Category; UPVC Valves

Single union ball valve with safety lock



MM (20 up to 110)  
TH (1/2" up to 4")  
BS (1/2" up to 4")

Double union ball valve with safety lock



MM (20 up to 110)  
TH (1/2" up to 4")  
BS (1/2" up to 4")

Double union compression valve



MM (25 up to 63)

Single union compression valve



From (3/4" x 25)  
to (2" x 63)

Check Valve



MM (20 up to 110)  
TH (1/2" up to 4")  
BS (1/2" up to 4")

Transparent Check Valve



MM (20 up to 110)

Flap Valve



MM (63/2 up to 225/8)

Valve Saddle



MM (75x32 up to 225x63)  
TH (75x1" up to 225x2")

## NEISCO Product Category; Butterfly Valves



Butterfly valve

(90 MM - 110 MM)

# NEISCO Product Category; PP Compression Fittings



**Elbow 90°**



(20x20 up to 110x110)

**Elbow 90° with threaded male offtake**



(20x1/2" up to 63x2")

**Elbow 90° with threaded female offtake**



(20x1/2" up to 90x3")

**Adaptor Male Threaded**



(20x1/2" up to 110x4")

**Bouchon**



(20 up to 110)

**Coupling**



(20x20 up to 110x110)

**Reducing Coupling**



(32x25 up to 75x63)

**Adaptor Female Threaded**



(20x1/2" up to 90x3")

**Tee 90°**



(20 up to 110)

**Tee 90° with threaded male offtake**



(20x1/2" up to 63x2")

**Tee 90° with threaded female offtake**



(20x1/2" up to 90x3")

★ **Saddles**



2/4/6 Bolts  
(32x1/2" up to 160x4")

★ **Double Saddles**



2/4/6 Bolts  
(32x1/2" up to 160x4")

**GR Drip Line**



PC & Non-PC  
(2 & 4 LPH)

**In-Line Drippers**



PC & Non-PC  
(2/4/6 LPH)

**On-Line Drippers**



PC & Non-PC  
(2/4/8/16 LPH)

★ Available with or without metal rings

# UPVC PRESSURE FITTINGS



## General properties

### Material

#### U-PVC PIPE SYSTEMS

U-PVC (unplasticized polyvinyl chloride) is one of the most popular thermoplastic materials used for pipe work installations; it is obtained from ethylene (43%) and chlorine (57%). Light, U-PVC has excellent resistance to chemicals and abrasion, is tasteless and odorless making it ideal for use with potable water systems. Its extremely smooth bore gives excellent low characteristic without sediment or deposit. Connections can be made by either solvent cement or BSP threaded fittings.

#### MATERIALS

Fittings: U-PVC (unplasticized polyvinyl chloride)  
 Gaskets: EPDM (ethylene - polypropylene rubber)  
 FPM (fluorocarbonic - rubber)

#### PRESSURE-TEMPERATURE RELATIONSHIP

The maximum working pressure is 16 kg/cm<sup>2</sup> (227,6 PSI) from -20°C to +25°C.  
 Above +25°C the working pressure decreases by a linear way down to 4 kg/cm<sup>2</sup> (56,9 PSI) to +60°C

#### Pressure-Temperature relationship according to DIN 3441 BLATT 1

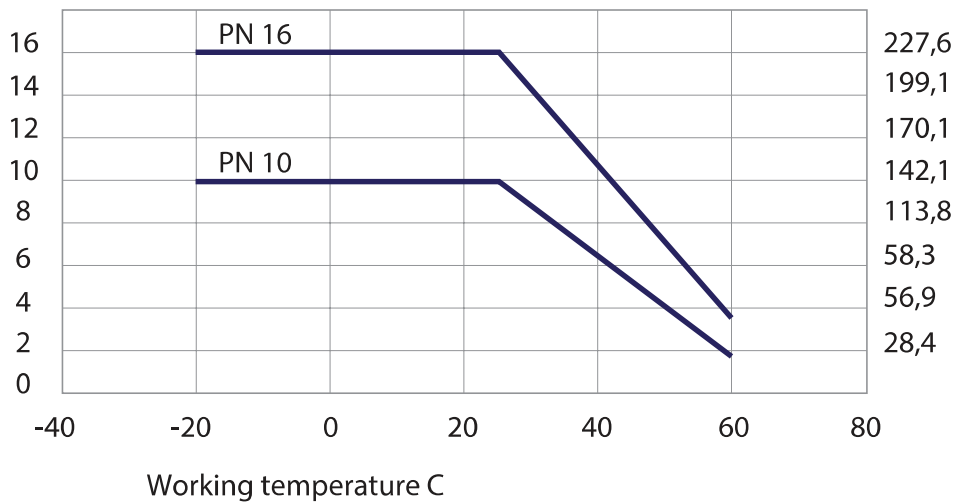



## Mechanical properties

Max working pressure in Kg/cm

Series	Dimensions	NP
Solvent jointing	from D16 to D160	16
Solvent jointing	from D200 to D315	10
Threaded	from G3/8 to G4	16
Adaptor set	from D16 to D110	16

Safety factor at 20°C

NP	HOURS 1	HOURS 1000	Corrisp. to 50 years
10 Bar	6.7	5.1	4.0
16 Bar	4.2	3.2	2.5

## Chemical resistance

U-PVC has chemical resistance properties which are excellent being resistant to most solutions of salts, acids, alkalis and watersoluble solvents. PVC is NOT resistant to aromatic or chlorinated hydrocarbons.

## Abbreviations

- D** connecting size for plastic piping corresponding to external diameter of pipe and internal diameter of female fittings.
- D"** nominal diameter for connecting B.S. piping (inches)
- DN** nominal diameter for metal pipes corresponding approximately to internal diameter
- G** nominal diameter for threaded pipes and fittings (inches)

## Physical properties of U-PVC

Characteristics	Method	Units	UPVC
Density	DIN 53479	g / cm <sup>3</sup>	1.4
Elongation	ISO R527	%	125
Modulus to traction	ISO R527	Kg / cm <sup>2</sup>	30.000
Resistance to traction	ISO R527	N / mm <sup>2</sup>	55
Tensile Strength	ISO R527	Kg / cm <sup>2</sup>	520
ZOD Impact strength at 23°C	ASTM D256	Kg cm / cm	3,5/4,5
Vicat softening point with 5 Kgs	ISO R306	°C	76
Thermal conductivity	ASTM C177	kcal / mh°C	0,15
Coefficient of linear expansion	ASTM D696	m / m°C	8x10
Water absorption	ISO R527	mg / cm <sup>3</sup>	<4
Flammability			Self extinguishing M1

## Pipe fitting tolerances for solvent joint according to:

Fittings: ISO 727, DIN 8063, KIWA BRL-K 504, NF T54-028, UNI EN ISO 1452 ]

Pipes: ISO 161, DIN 8062, KIWA 49, NFT54-016

D	DN Nominal Diameter	Mean outside diameter of fittings		Mean inside diameter of fittings	
		Min	Max	Min	Max
16	10	16	16.2	16.1	16.3
20	15	20	20.2	20.1	20.3
25	20	25	25.2	25.1	25.3
32	25	32	32.2	32.1	32.3
40	32	40	40.2	40.1	40.3
50	40	50	50.2	50.1	50.3
63	50	63	63.2	63.1	63.3
75	65	75	75.2	75.1	75.3
90	80	90	90.2	90.1	90.3
110	100	110	110.3	110.1	110.4
125	110	125	125.3	125.1	125.4
140	125	140	140.3	140.2	140.5
160	150	160	160.3	160.2	160.5
200	175	200	200.4	200.2	200.6
225	200	225	225.4	225.3	225.7
250	225	250	250.5	250.3	250.8
280	250	280	280.5	280.3	280.9
315	280	315	315.5	315.4	316

## Threading dimension according to:

ISO 7/1, UNI ISO 228/1, BS 21, DIN 2999

G Nominal Diameter	Diameter of screw	Passo Pitch		Depth of thread	Length of thread assembling
		N° fil/1"	mm		
3/8"	16.66	19	1.337	0.856	11.04
1/2"	20.95	14	1.814	1.162	15
3/4"	26.44	14	1.814	1.162	16.3
1"	33.25	11	2.309	1.479	19.1
1 1/4"	41.91	11	2.309	1.479	21.4
1 1/2"	47.8	11	2.309	1.479	21.4
2"	59.61	11	2.309	1.479	25.7
2 1/4"	65.71	11	2.309	1.479	-
2 1/2"	75.18	11	2.309	1.479	30.2
2 3/4"	81.53	11	2.309	1.479	-
3"	87.88	11	2.309	1.479	33.3
4"	113.03	11	2.309	1.479	39.3
5"	138.43	11	2.309	1.479	43.6
6"	163.83	11	2.309	1.479	43.6



**EL50**  
90° ELBOW  
كوع 90°

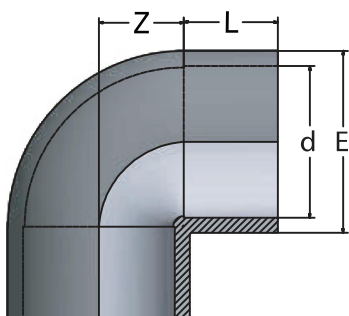

Code	d	L	Z	E	PN	GR.	Pack	Size
EL50N0200	20	16	11	27	16	16	300	S
EL50N0250	25	19	13.5	33	16	29	350	M
EL50N0320	32	22	17	41	16	55	200	M
EL50N0400	40	26	21	50	16	90	140	L
EL50N0500	50	31	26	61	16	135	140	L
EL50N0630	63	38	32.5	76	16	247	70	L
EL50N0750	75	44	38.5	90	16	375	40	L
EL50N0900	90	51	46	108	16	565	25	L
EL50N1100	110	61	56	131	16	1060	14	L
EL50N1250	125	69	63	148	16	1420	10	L
EL50C1400	140	76	71	165	16	1990	6	L
EL50N1600	160	86	81	188	16	3200	4	L
EL50N2000	200	106	101	232	10	5850	2	L
EL50N2250	225	118.5	114	258	10	7500	1	L
EL50N2500	250	131	188	286	10	12150	10	XL

**TE40**  
90° TEE  
مشارك 90°

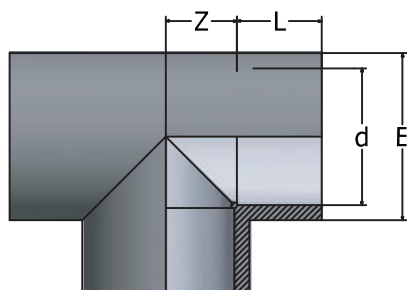

Code	d	L	Z	E	PN	GR.	Pack	Size
TE40N0200	20	16	11	27	16	25	450	M
TE40N0250	25	19	13.5	33	16	44	250	M
TE40N0320	32	22	17	41	16	69	130	M
TE40N0400	40	26	21	51	16	125	80	M
TE40N0500	50	31	26	61	16	183	90	L
TE40N0630	63	38	32.5	76	16	315	50	L
TE40N0750	75	44	38.5	90	16	495	32	L
TE40N0900	90	51	46	108	16	790	20	L
TE40N1100	110	61	56	131	16	1454	10	L
TE40N1250	125	69	63	148	16	1850	7	L
TE40N1400	140	76	71	165	16	2.61	4	L
TE40N1600	160	86	81	188	16	4280	3	L
TE40N2000	200	106	101	232	10	7200	20	XL
TE40N2250	225	118.5	114	258	10	9700	15	XL
TE40N2500	250	131	126	286	10	12650	10	XL



## EY50

45° ELBOW

كوع 45°

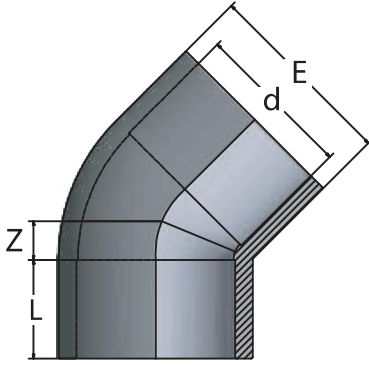

Code	d	L	Z	E	PN	GR.	Pack	Size
EY50N0200	20	16	5.5	27	16	17	700	M
EY50N0250	25	19	6	33	16	30	450	M
EY50N0320	32	22	7.5	41	16	47	250	M
EY50N0400	40	26	9.5	50	16	77	150	M
EY50N0500	50	31	11.5	61	16	115	170	L
EY50N0630	63	38	14	76	16	190	90	L
EY50N0750	75	44	16.5	90	16	310	50	L
EY50N0900	90	51	19.5	108	16	485	30	L
EY50N1100	110	61	24	131	16	835	16	L
EY50N1250	125	69	27	148	16	1065	12	L
EY50N1400	140	76	30	165	16	1640	6	L
EY50N1600	160	86	34	188	16	2100	4	L
EY50N2000	200	106	43	232	10	4540	30	XL
EY50N2250	225	119	48	258	10	6200	26	XL
EY50N2500	250	132	53	287	10	7680	16	XL

## SO10

SOCKET

جلبة

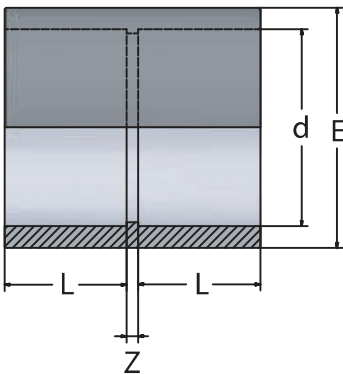

Code	d	L	Z	E	PN	GR.	Pack	Size
SO10N0200	20	16	3	27	16	15	380	S
SO10N0250	25	19	3	33	16	23	500	M
SO10N0320	32	22	3	41	16	36	300	M
SO10N0400	40	26	3	51	16	60	200	M
SO10N0500	50	31	3	61	16	85	220	L
SO10N0630	63	38	3	76	16	145	125	L
SO10N0750	75	44	4	90	16	214	85	L
SO10N0900	90	51	5	108	16	365	45	L
SO10N1100	110	61	6	131	16	520	27	L
SO10N1250	125	69	6	148	16	807	20	L
SO10N1400	140	76	8	165	16	1100	12	L
SO10N1600	160	86	8	188	16	1400	8	L
SO10N2000	200	106	8	226	10	2660	50	XL
SO10N2250	225	119	12	258	10	4436		



## RP20 REDUCING PIECE

M/F

مسلوب طويل

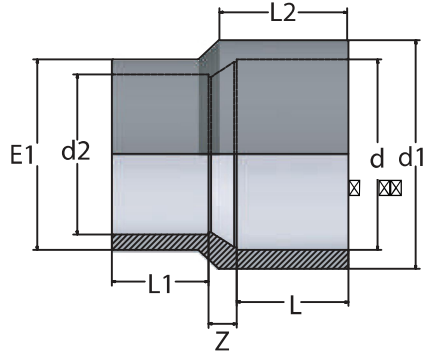

Code	dxd1xd2	L	L1	L2	Z	E	PN	Gr	Pack	Box
RP20N032B	25x32x20	19	16	22	6	32	16	17	300	S
RP20N040B	32x40x20	22	16	26	9	32	16	27	200	S
RP20N040C	32x40x25	22	19	26	8	40	16	28	170	S
RP20N050B	40x50x20	26	16	31	9	50	16	46	230	M
RP20N050C	40x50x25	26	19	31	12	50	16	49	230	M
RP20N050D	40x50x32	26	22	31	9	50	16	53	200	M
RP20N063C	50x63x25	31	19	38	19	63	16	85	130	M
RP20N063D	50x63x32	31	22	38	12	63	16	88	125	M
RP20N063E	50x63x40	31	26	38	12	63	16	93	120	M
RP20N075E	63x75x40	38	26	44	17	75	16	140	80	M
RP20N075F	63x75x50	38	31	44	12	75	16	124	80	M
RP20N090F	75x90x50	44	31	51	18	90	16	203	45	M
RP20N090G	75x90x63	44	38	51	11	90	16	225	36	M
RP20N110F	90x110x50	51	31	61	28	110	16	362	45	L
RP20N110G	90x110x63	51	38	61	22	110	16	375	45	L
RP20N110H	90x110x75	51	44	61	16	110	16	396	45	L
RP20N125F	110x125x50	61	31	69	34	125	16	376	42	L
RP20N125G	110x125x63	61	38	69	28	125	16	393	42	L
RP20N125H	110x125x75	61	44	69	23	125	16	432	42	L
RP20N125I	110x125x90	61	51	69	17	125	16	486	42	L

## RS10 REDUCING SOCKET

جلبة مسلوقة

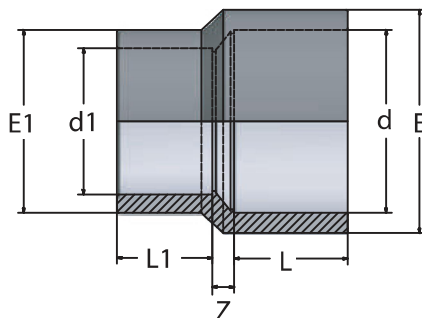

Code	dxd1	L	L1	Z	E	E1	PN	Gr	Pack	Box
RS10N160L	160x110	86	61	28	180	129	16	1250	12	L
RS10N200O	200x160	106	86	49	226	180	10	2560	4	L
RS10N225O	225x160	119	85	42	254	183	10	3255	3	L

## TR40

### 90° TEE REDUCED

مشترك مخفض

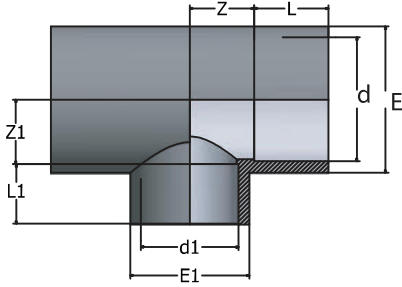

Code	dxd1	L	L1	Z	Z1	E	E1	PN	GR.	Pack	Size
TR40N032B	32x20	22	16	17	17	41	27	16	69	160	M
TR40N032C	32x25	22	19	17	17	41	33	16	70	140	M
TR40N050B	50x20	31	16	26	26	61	27	16	165	110	M
TR40N050C	50x25	31	19	26	26	61	33	16	166	110	M
TR40N050D	50x32	31	22	26	26	61	41	16	170	110	L
TR40N063B	63x20	38	16	32.5	26	76	27	16	236	70	L
TR40N063C	63x25	38	19	32.5	33	76	33	16	282	70	L
TR40N063D	63x32	38	22	32.5	33	76	41	16	279	70	L
TR40N063F	63x50	38	31	32.5	33	76	61	16	292	60	L
TR40N075D	75x32	44	22	38.5	39	90	41	16	453	38	L
TR40N075E	75x40	44	26	38.5	39	90	51	16	465	38	L
TR40N075F	75x50	44	31	38.5	39	90	61	16	465	35	L
TR40N075G	75x63	44	38	38.5	39	90	76	16	469	35	L
TR40N090E	90x40	51	26	46	47	108	51	16	714	24	L
TR40N090F	90x50	51	31	46	47	108	61	16	721	24	L
TR40N090G	90x63	51	38	46	47	108	75	16	740	22	L
TR40N090H	90x75	51	44	46	47	108	90	16	760	22	L
TR40N110F	110x50	61	31	56	57	131	61	16	1250	12	L
TR40N110G	110x63	61	38	56	57	131	76	16	1.2	12	L
TR40N110H	110x75	61	44	56	57	131	90	16	1.22	12	L
TR40N110I	110x90	61	51	56	57	131	108	16	1.25	10	L
TR40N160I	160x90	86	51	81	82	188	108	16	3069	3	L
TR40N160L	160x110	86	61	81	82	188	131	16	3152	2	L
<b>TR40N200N</b>	<b>200x160</b>	<b>106</b>	<b>86</b>	<b>101</b>	<b>128</b>	<b>288</b>	<b>188</b>	<b>10</b>	<b>6687</b>	<b>1</b>	<b>L</b>
<b>TR40N200L</b>	<b>200x110</b>	<b>106</b>	<b>61</b>	<b>101</b>	<b>128</b>	<b>228</b>	<b>61</b>	<b>10</b>	<b>5394</b>	<b>1</b>	<b>L</b>

## ST20

### STUB SERRATED

بردة

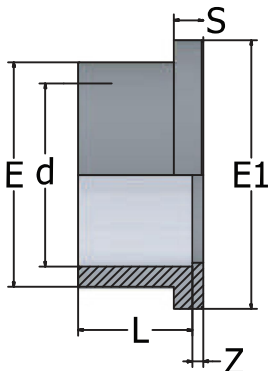

Code	d	DN	L	Z	S	E	E1	PN	GR	Pack	Box
ST20N0250	25	20	19	3	6	33	41	16	16	550	S
ST20N0320	32	25	22	3	6	41	50	16	25	300	S
ST20N0400	40	32	26	3	8	50	61	16	40	250	M
ST20N0500	50	40	31	3	8	61	73	16	60	180	M
ST20N0630	63	50	38	3	8	76	90	16	113	90	M
ST20N0750	75	65	44	3	8	90	106	16	160	120	L
ST20N0900	90	80	51	5	10	108	125	16	263	70	L
ST20N1100	110	100	61	5	11	131	150	16	430	45	L
ST20N1250	125	110	68.5	5	11	148	167	16	540	25	L
ST20N1400	140	125	76	5	11	165	187	16	744	20	L
ST20N1600	160	150	86	5	11	188	213	16	1052	16	L
ST20N2000	200	200	106	7	18	228	253	10	1850	7	L
ST20N2250	225	200	118.5	8	19	247	274	10	1768	6	L
ST20N2500	250	225	131	10	20	273	307	10	2.32	4	L
ST20N3150	315	300	163.5	11	27	346	379	10	4.58	3	L



## RB90

### REDUCING BUSH

بوش قصير

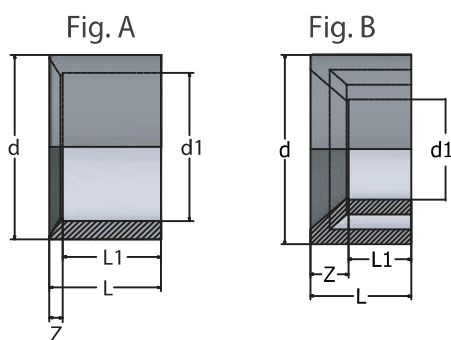

Code	dxd1	L	L1	Z	Fig	PN	Gr	Pack	Box
RB90N025B	25x20	19	16	3	A	16	4	700	S
RB90N032B	32x20	22	16	6	A	16	15	450	S
RB90N032C	32x25	22	19	3	A	16	10	450	S
RB90N040B	40x20	26	16	10	B	16	25	270	S
RB90N040C	40x25	26	19	7	A	16	28	270	S
RB90N040D	40x32	26	22	4	A	16	16	270	S
RB90N050C	50x25	31	19	14	B	16	45	350	M
RB90N050D	50x32	31	22	9	B	16	41	350	M
RB90N050E	50x40	31	26	5	A	16	31	350	M
RB90N063C	63x25	38	19	19	B	16	71	180	M
RB90N063D	63x32	38	22	16	B	16	73	180	M
RB90N063E	63x40	38	26	12	B	16	76	180	M
RB90N063F	63x50	38	31	7	A	16	61	180	M
RB90N075D	75x32	44	22	22	B	16	128	110	M
RB90N075E	75x40	44	26	18	B	16	102	160	M
RB90N075F	75x50	44	31	14	B	16	122	110	M
RB90N075G	75x63	44	38	6	A	16	85	110	M
RB90N090F	90x50	51	31	20	B	16	171	65	M
RB90N090G	90x63	51	38	13	B	16	166	65	M
RB90N090H	90x75	51	44	7	A	16	140	65	M
RB90N110G	110x63	61	38	23	B	16	254	40	M
RB90N110H	110x75	61	44	17	B	16	262	40	M
RB90N110I	110x90	61	51	10	A	16	266	40	M
RB90N125L	125x110	68.5	61	8	A	16	260	50	L
RB90N140M	140x125	76	68.5	7	A	16	335	40	L
RB90N160I	160x90	86	51	30	B	16	850	24	L
RB90N160L	160x110	86	61	25	B	16	820	24	L
RB90N160M	160x125	86	68.5	17	B	16	745	24	L
RB90N160N	160x140	86	76	10	A	16	565	24	L
RB90N200O	200x160	106	86	20	B	10	1381	12	L
RB90N225O	225x160	118.5	86	33	B	10	2411	7	L
RB90N225P	225x200	118.5	106	13	A	10	1408	7	L
RB90N250O	250x160	131	86	47	B	10	2798	6	L
RB90N250P	250x200	131	106	27	B	10	1752	6	L
RB900250Q	250x225	131	118.5	12	A	10	2.1	6	L

## CA70

CAP

طبة

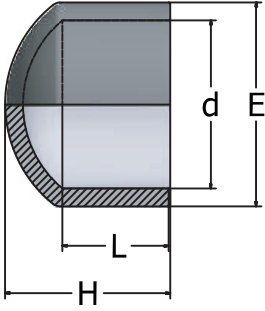

Code	d	L	H	E	PN	Gr	Pack	Box
CA70N0200	20	16	27	27	16	10	500	S
CA70N0250	25	19	31	33	16	18	350	S
CA70N0320	32	22	36	41	16	30	450	M
CA70N0400	40	26	43	50	16	45	300	M
CA70N0500	50	31	49	61	16	70	180	M
CA70N0630	63	38	57	76	16	120	100	M
CA70N0750	75	44	67	90	16	188	60	M
CA70N0900	90	51	80	106	16	295	65	L
CA70N1100	110	61	95	131	16	490	40	L
CA70N1250	125	69	102	148	16	680	33	L
CA70N1400	140	76	114	165	16	927	20	L
CA70N1600	160	86	126	188	16	1146	14	L
CA70N2000	200	106	145	228	10	2048	7	L
CA70N2250	225	119	160	254	10	2684	6	L
CA70N2500	250	106	208	286	10	3925	4	L

## BR00

LOOSE FLANGE  
DIN 8063 PN 10-16

فلانشة متحركة

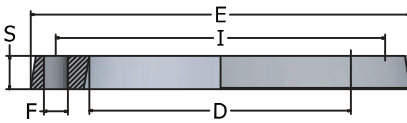

Code	d	DN	D	E	S	I	F	Drill	Bolts	PN	GR
BR00N0500	50	40	62	152	16	110	18	4	M16x75	16	230
BR00N0630	63	50	78	165	18	125	18	4	M16x80	16	280
BR00N0750	75	65	92	185	19	145	18	4	M16x90	16	355
BR00N0900	90	80	110	200	20	160	18	8	M16x90	16	430
BR00N1100	110	100	133	220	22	180	18	8	M16x100	16	520
BR00N1250	125	110	149	230	24	190	18	8	M16x100	16	964
BR00N1400	140	125	167	250	26	210	18	8	M16x110	16	1165
BR00N1600	160	150	190	285	28	240	22	8	M20x120	16	930
BR00N2000	200	200	235	340	30	295	22	8	M20x120	10	1.2
BR00N2250	225	200	250	340	30	295	22	8	M20x120	10	2484
BR00N2500	250	225	280	395	34	350	22	12	M20x120	10	1.7
BR00N3150	315	300	349	445	34	400	22	12	M20x120	10	2.7



## SA50

### SADDLE WITH STAINLESS STEEL BOLT AND NUT

ركاب بأربع مسامير

Code	dxd1	L	L1	Z	Fig	PN	Gr	Pack	Box
SA51N075C	75x¾"	22	19	134	105	54	683	25	L
SA51N075D	75x1"	30	22	134	105	54	692	25	L
SA51N075F	75x1½"	31	25	134	105	54	725	25	L
SA51N075G	75x2"	31	30	134	105	54	780	25	L
SA51N090C	90x¾"	22	19	152	105	61	764	20	L
SA51N090D	90x1"	28	22	152	105	61	778	20	L
SA51N090F	90x1½"	40	25	152	105	61	805	20	L
SA51N090G	90x2"	40	30	152	105	61	877	20	L
SA51N110C	110x¾"	22	19	176	105	72	982	20	L
SA51N110D	110x1"	28	22	176	105	72	993	20	L
SA51N110F	110x1½"	40	25	176	105	72	1.02	20	L
SA51N110G	110x2"	40	30	176	105	72	1.08	20	L
SA51N125D	125x1"	25	22	190	112	80	1.26	20	L
SA51N125F	125x1½"	40	25	190	112	80	1.32	20	L
SA51N125G	125x2"	50	30	190	112	80	1.41	20	L
SA51N160D	160x1"	28	22	233	120	98	1.45	10	L
SA51N160F	160x1½"	40	25	233	120	98	1.48	10	L
SA51N160G	160x2"	50	30	233	120	98	1.52	10	L
SA51N200F	200x1½"	40	25	300	133	118	2.06	7	L
SA51N200G	200x2"	52	30	300	133	118	2.12	7	L
SA51N200I	200x3"	52	36	300	133	118	2.15	7	L
SA51N225F	225x1½"	40	25	333	125	132	2.61	7	L
SA51N225G	225x2"	50	30	333	125	132	2.65	7	L
SA51N225I	225x3"	74	36	333	125	132	2.74	7	L

## UN80

### UNION WITH O-RING

لاكور تجميع

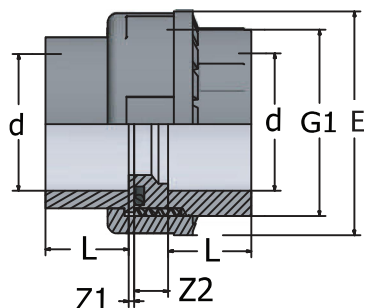

Code	d	L	Z1	Z2	G1	E	O-Ring	PN	GR	Pack	Box
UN80N0200	20	16	3	10	1"	42	4081	16	42	180	S
UN80N0250	25	19	3	10	1¼"	52	4112	16	70	220	M
UN80N0320	32	22	3	10	1½"	59	4131	16	97	150	M
UN80N0400	40	26	3	12	2"	72	6162	16	155	80	M
UN80N0500	50	31	3	14	2¼"	79	6187	16	194	120	L
UN80N0630	63	38	3	18	2¾"	96	6237	16	333	60	L
UN80N0750	75	44	3	18	3½"	119	6312	16	580	35	L
UN80N0900	90	51	5	18	4"	134	6362	16	760	24	L
UN80N1100	110	61	5	18	5"	163	6450	16	1280	12	L

**EL51****90° ELBOW THREADED**

كوع سن 90°

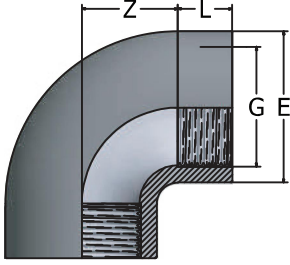

Code	G	L	Z	E	PN	Gr.	Pack	Box
EL51N0200	1/2"	16.5	11	27	16	17	300	S
EL51N0250	3/4"	19.5	13.5	33	16	30	300	M
EL51N0320	1"	22.5	17	41	16	53	300	M
EL51N0400	1 1/4"	27	21	50	16	85	300	M
EL51N0500	1 1/2"	30	26	61	16	180	300	L
EL51N0630	2"	36	32.5	76	16	340	300	L
EL51N0750	2 1/2"	50.5	38.5	90	16	436	40	L

**EY51****45° ELBOW THREADED**

كوع سن 45°

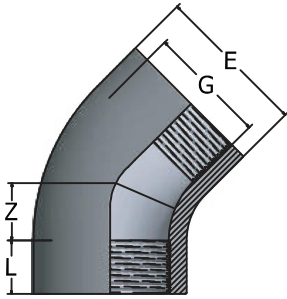

Code	G	L	Z	E	PN	Gr.	Pack	Box
EY51N0500	1 1/2"	30	11.5	61	16	145	170	L
EY51N0630	2"	36	14	76	16	254	90	L

**TE41****90° TEE THREADED**

مشارك سن 90°

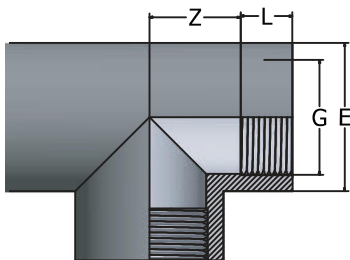

Code	G	L	Z	E	PN	Gr.	Pack	Box
TE41N0200	1/2"	16.5	11	27	16	26	450	M
TE41N0250	3/4"	19.5	13.5	33	16	43	250	M
TE41N0320	1"	22.5	17	41	16	80	130	M
TE41N0400	1 1/4"	27	21	50	16	120	80	M
TE41N0500	1 1/2"	30	26	61	16	240	90	L
TE41N0630	2"	36	32.5	76	16	425	50	L





## RE61

REDUCER MALE/ FEMALE

مسلوب سن خارجی / سن داخلی

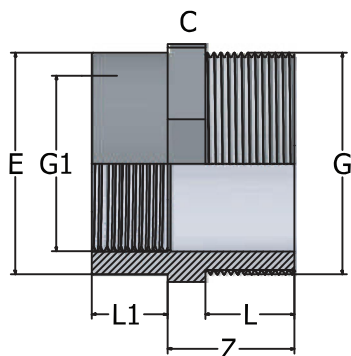

Code	GxG1	L	L1	Z	C	E	PN	Gr	Pack	Box
RE61N025B	3/4" x 1/2"	16.5	15.5	26	30	33	16	17	320	S
RE61N032B	1" x 1/2"	19.5	16.5	29	36	41	16	17	220	S
RE61N032C	1" x 3/4"	19.5	19.5	30	36	41	16	26	450	M
RE61N050D	1 1/2" x 1"	30	22.5	34	50	61	16	55	200	M
RE61N063C	2" X 3/4"	36	19.5	37	65	76	16	85	160	M
RE61N063D	2" x 1"	36	22.5	37	65	76	16	97	120	M
RE61N063E	2" x 1 1/4"	36	27	37	65	76	16	94	110	M
RE61N063F	2" x 1 1/2"	36	21	37	65	76	16	96	110	M

## UN81

UNION WITH O-RING THREADED

لاکور تجميع سن

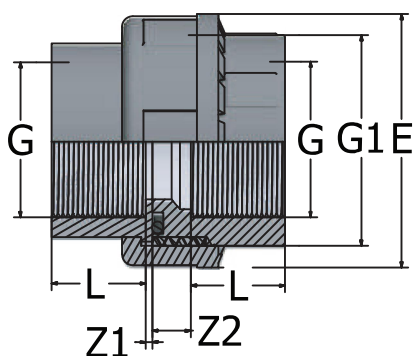

Code	G	L	Z1	Z2	G1	E	O-ring	Gr	Pack	Box
UN81N0200	1/2"	16.5	4	11	1"	27	4081	45	180	S
UN81N0250	3/4"	19.5	5.7	13	1 1/4"	33	4112	72	220	M
UN81N0320	1"	22.5	5.9	13	1 1/2"	41	4131	100	150	M
UN81N0400	1 1/4"	27	7.6	17	2"	50	6162	160	80	M
UN81N0500	1 1/2"	30	13	24	2 1/4"	61	6187	220	60	M
UN81N0630	2"	36	15	30	2 3/4"	76	6237	400	30	M
UN810750	2 1/2"	36	17	32	3 1/2"	108	6312	635	35	L
UN810900	3"	50.5	23	36	4"	90	6362	850	24	L
UN811100	4"	63	27	40	5"	131	6450	1260	12	L

## SO11

### SOCKET THREADED

جلبة سن

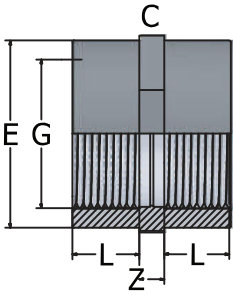

Code	G	L	Z	E	C	PN	Gr	Pack	Box
SO11N0200	1/2"	16.5	7	27	30	16	18	350	S
SO11N0250	3/4"	19.5	7	33	36	16	25	500	M
SO11N0320	1"	22.5	8	41	46	16	45	300	M
SO11N0400	1 1/4"	27	8	50	55	16	65	180	M
SO11N0500	1 1/2"	30	8	61	60	16	70	160	M
SO11N0630	2"	36	8	76	75	16	125	85	M
SO11N0750	2 1/2"	36	9	90	90	16	200	48	M

## NI61

### NIPPLE THREADED

نبل سن

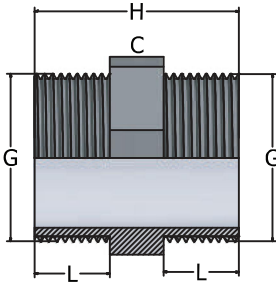

Code	G	L	H	C	PN	Gr	Pack	Box
NI61N0200	1/2"	16.5	42	24	16	11	500	S
NI61N0250	3/4"	19.5	44	30	16	18	450	M
NI61N0320	1"	22.5	50	36	16	28	450	M
NI61N0400	1 1/4"	27	58	46	16	47	240	M
NI61N0500	1 1/2"	30	58	55	16	61	160	M
NI61N0630	2"	36	66	65	16	98	200	L

## CA71

### CAP THREADED

طبة سن

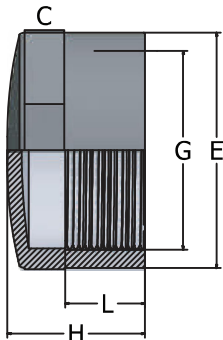

Code	G	L	H	E	C	PN	Gr	Pack	Box
CA71N0200	1/2"	16.5	26	28	30	16	13	450	S
CA71N0250	3/4"	19.5	28	34	36	16	19	280	S
CA71N0320	1"	22.5	32	42	46	16	30	180	S
CA71N0400	1 1/4"	27	35	51	55	16	56	120	S
CA71N0500	1 1/2"	30	35	58	60	16	84	230	M
CA71N0630	2"	36	39	72	75	16	113	125	M
CA71N0900	3"	50.5	56	103	105	16	270	45	M
CA71N1100	4"	63	64	130	130	16	499	30	M



## EL52

90° ELBOW PLAIN/ THREADED

كوع 90° لصق / سن

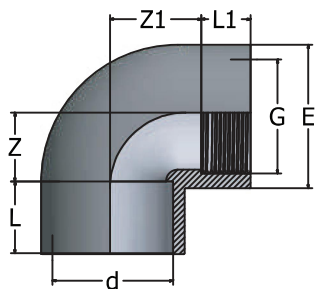

Code	dxG	L	L1	Z	Z1	E	PN	Gr	Pack	Box
EL52N020B	20X1/2	16	15	11	12	27	16	20	300	S
EL52N025C	25X3/4	19	16	13.5	16	33	16	35	350	M
EL52N032D	32X1	22	19	17	20	41	16	60	200	M
EL52N040E	40x1.1/4"	26	21	21	20	50	16	90	120	M
EL52N050F	50X11/2	31	21	26	28	61	16	155	140	L
EL52N063G	63X2	38	26	32.5	38	76	16	290	70	L

## TE42

90° TEE PLAIN/ THREADED

مشترك 90° لصق / سن

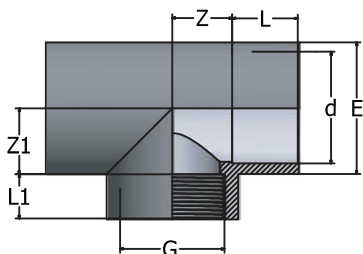

Code	dxG	L	L1	Z	Z1	E	Gr	Pack	Box
TE42N020B	20X1/2	16	15	11	12	27	25	200	S
TE42N025C	25X3/4	19	16	13.5	16	33	45	250	M
TE42N032D	32X1	22	19	17	20	41	75	130	M
TE42N040E	40/1.1/4"	26	21	21	20	50	120	80	M
TE42N050F	50X11/2	31	21	26	28	61	195	90	L
TE42N063G	63X2	38	26	32.5	38	76	350	50	L

## TR42

90° TEE REDUCED  
PLAIN/ THREADED

مشترك مخفض 90° لصق / سن

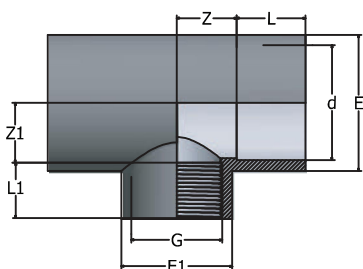

Code	dxG	L	L1	Z	Z1	E	E1	Gr	Pack	Box
TR42N032C	32 x 3/4	22	19	17	17	41	33	68	140	M
TR42N050B	50 x 1/2	31	16	26	26	61	27	165	50	M
TR42N050D	50 x 1	31	22	26	26	61	41	170	50	M
TR42N063B	63 X 1/2	38	16	32.5	33	76	27	280	30	M
TR42N063D	63 x 1"	38	26	32.5	29.5	75	41.5	305	70	L

## AD12

### MALE ADAPTOR

رأس خط سن خارجی

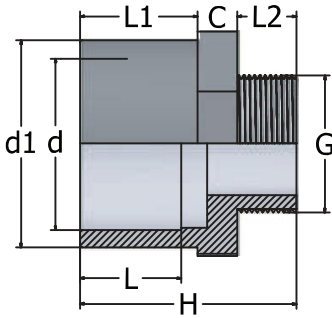

Code	dx <sub>d1</sub> xG	L	L1	L2	H	C	PN	Gr	Pack	Box
AD12N020B	20x25x1/2"	16	19	15	46	27	16	15	350	S
AD12N025B	25x32x1/2"	19	22	15	49	36	16	25	500	M
AD12N025C	25x32x3/4"	19	22	16	50	36	16	26	480	M
AD12N025D	25x32x1"	19	22	19	53	36	16	30	400	M
AD12N032C	32x40x3/4"	22	26	16	54	42	16	35	330	M
AD12N032D	32x40x1"	22	26	19	57	42	16	40	300	M
AD12N040E	40x50x1"1/4	26	31	21	67	55	16	75	150	M
AD12N040F	40x50x1"1/2	26	31	21	67	55	16	77	140	M
AD12N050F	50x63x1"1/2	31	38	21	74	65	16	113	120	M
AD12N050G	50x63x2"	31	38	26	78	65	16	120	170	L
AD12N063F	63x75x1"1/2	38	44	21	80	75	16	160	90	M
AD12N063G	63x75x2"	38	44	26	84	75	16	150	90	M
AD12N075G	75x90x2"	44	51	26	94	95	16	280	45	M
AD12N075H	75x90x2"1/2	44	51	30	99	95	16	270	45	M
AD12N075I	75x90x3"	44	51	30	102	95	16	288	60	L
AD12N090H	90x110x2"1/2	51	61	30	110	115	16	475	45	L
AD12N090I	90x110x3"	51	61	33	110	115	16	490	45	L
AD12N110I	110x125x3"	61	69	33	115	130	16	485	42	L
AD12N110L	110x125x4"	61	69	39	120	130	16	490	30	L

## RB92

### ADAPTOR REDUCING BUSH

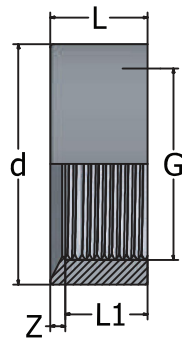

Code	dxG	L	L1	Z	PN	Gr	Pack	Box
RB92N032B	32x1/2"	23	16	7.0	16	15	450	S
RB92N032C	32x3/4"	16	16	5.7	16	12	450	S
RB92N040D	40x1"	19	19	6.9	16	22	270	S
RB92N050E	50x1"1/4	22	21	9.6	16	40	350	M



## SO12

### FEMALE ADAPTOR

جلبة لصق / سن

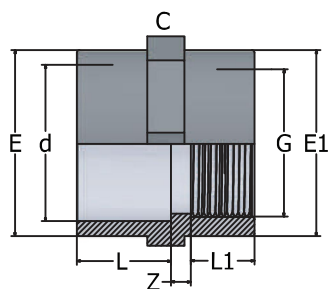

Code	dxG	L	L1	Z	E	E1	C	PN	Gr	Pack	Box
SO12N020B	20X1/2	16	16.5	3	27	27	30	16	15	350	S
SO12N025C	25X3/4	19	19.5	3	33	34	34	16	25	250	S
SO12N032D	32X1	22	22.5	3	41	41	42	16	38	300	M
SO12N040E	40X1 1/4"	26	27	3	50	50	55	16	61	180	M
SO12N050F	50X1 1/2"	31	30	3	61	60	65	16	95	120	M
SO12N063G	63X2	38	36	3	76	75	75	16	143	75	M
SO12N075H	75*2 1/2"	44	30	4	90	89	90	16	215	45	M
SO12N090I	90x3"	51	50	5	108	106	110	16	340	54	L
SO12N110L	110x4"	61	63	6	131	129	129	16	505	30	L

## UN82

### UNION WITH O-RING PLAIN/ THREADED

لاكور تجميع لصق / سن

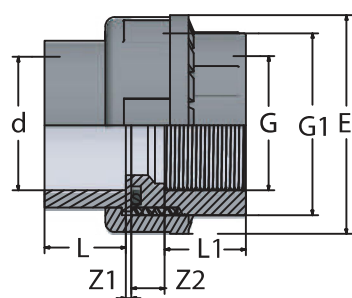

Code	dxG	L	L1	Z1	Z2	G1	E	O-Ring	Gr	Pack	Box
UN82N020B	20x1/2"	16	16.5	3	11	1"	42	4081	42	180	S
UN82N025C	25x3/4"	19	19.5	3	13	1 1/4"	52	4112	70	220	M
UN82N032D	32x1"	22	22.5	3	13	1 1/2"	59	4131	95	130	M
UN82N040E	40x1 1/4"	26	27	3	17	2"	72	6162	155	80	M
UN82N050F	50x1 1/2"	31	30	3	24	2 1/4"	79	6187	210	60	M
UN82N063G	63x2"	38	30	3	30	2 3/4"	96	6237	390	30	M
UN82N075H	75x2 1/2"	44	36	3	32	3 1/2"	119	6312	625	35	L
UN82N090I	90x3"	51	50	5	36	4"	134	6362	820	24	L
UN82N110L	110x4"	61	63	5	40	5"	163	6450	1280	12	L

**EL53**

90° ELBOW BS

كوع 90°

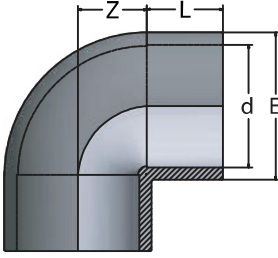

Code	d	L	Z	E	class	Gr	Pack	Box
EL53N0200	1/2"	16.5	11	27	E	15	300	S
EL53N0250	3/4"	19.5	13.5	33	E	24	350	M
EL53N0320	1"	22.5	17	41	E	42	200	M
EL53N0400	1 1/4"	27	21	50	E	72	120	M
EL53N0500	1 1/2"	30	26	61	E	150	140	L
EL53N0630	2"	36	32.5	76	E	285	70	L
EL53N0750	2 1/2"	44	38.5	90	E	380	40	L
EL53N0900	3"	50	46	108	E	655	25	L
EL53N1100	4"	63	56	131	E	1080	14	L

**EY53**

45° ELBOW BS

كوع 45°

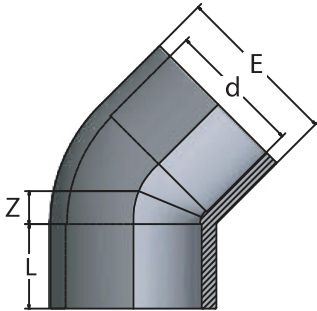

Code	d	L	Z	E	class	Gr	Pack	Box
EY53N0200	1/2"	16.5	5	27	E	15	700	M
EY53N0250	3/4"	19.5	6	33	E	25	450	M
EY53N0320	1"	22.5	7.5	41	E	41	250	M
EY53N0400	1 1/4"	27	9.5	50	E	59	150	M
EY53N0500	1 1/2"	30	11.5	61	E	125	140	L
EY53N0630	2"	36	14	76	E	215	70	L
EY53N0900	3"	50	19.5	108	E	500	30	L
EY53N1100	4"	63	24	131	E	920	16	L

**TE43**

90° TEE BS

مشارك 90°

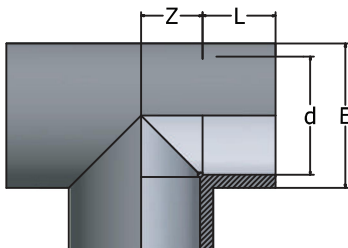

Code	d	L	Z	E	class	Gr	Pack	Box
TE43N0200	1/2"	16.5	11	27	E	21	450	M
TE43N0250	3/4"	19.5	13.5	33	E	35	250	M
TE43N0320	1"	22.5	17	41	E	63	130	M
TE43N0400	1 1/4"	26.5	21	50	E	101	80	M
TE43N0500	1 1/2"	30	26	61	E	207	90	L
TE43N0630	2"	36	32.5	76	E	365	50	L
TE43N0900	3"	50	46	108	E	837	20	L
TE43N1100	4"	63	56	131	E	1440	9	L



## SO13

SOCKET BS

جلبة

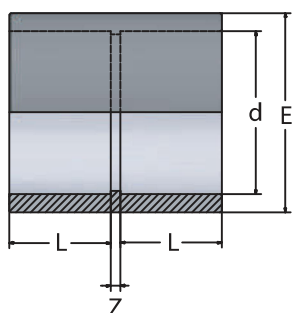

Code	d	L	Z	E	class	Gr	Pack	Box
SO13N0200	1/2"	16.5	3	27	E	13	380	S
SO13N0250	3/4"	19.5	3	33	E	20	500	M
SO13N0320	1"	22.5	3	41	E	33	300	M
SO13N0400	1 1/4"	27	3	50	E	50	200	M
SO13N0500	1 1/2"	30	3	61	E	89	220	L
SO13N0630	2"	36	3	76	E	168	125	L
SO13N0900	3"	50	5	108	E	372	45	L
SO13N1100	4"	63	6	131	E	620	27	L

## RB93

REDUCING BUSH BS

بوش قصير

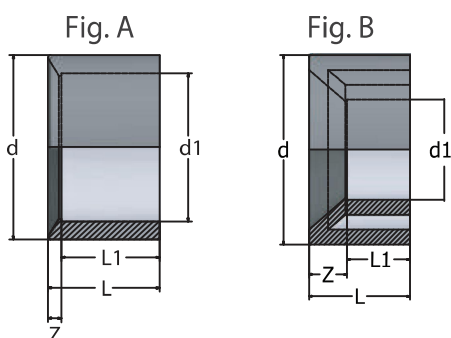

Code	dx d1	L	L1	Z	fig.	class	Gr	Pack	Box
RB93N025B	3/4" x 1/2"	19.5	16.5	3	A	E	5	700	S
RB93N032B	1" x 1/2"	22.5	16.5	6	A	E	12	400	S
RB93N032C	1" x 3/4"	22.5	19.5	3	A	E	6	400	S
RB93N040D	1 1/4" x 1"	27	22.5	4	A	E	15	250	S
RB93N050C	1 1/2" x 3/4"	30	19.5	12	B	E	29	350	M
RB93N050D	1 1/2" x 1"	30	22.5	9	B	E	32	350	M
RB93N050E	1 1/2" x 1 1/4"	30	27	5	A	E	17	350	M
RB93N063D	2" x 1"	36	22.5	16	B	E	52	180	M
RB93N063F	2" x 1 1/2"	36	30	7	A	E	41	180	M
RB93N090F	3" x 1 1/2"	50	30	20	B	E	159	65	M
RB93N090G	3" x 2"	50	36	13	B	E	137	65	M
RB93N110G	4" x 2"	63	36	23	B	E	337	36	M
RB93N110I	4" x 3"	63	50	10	A	E	246	36	M



## TR43

90° TEE REDUCED BS

مشترك مخفض

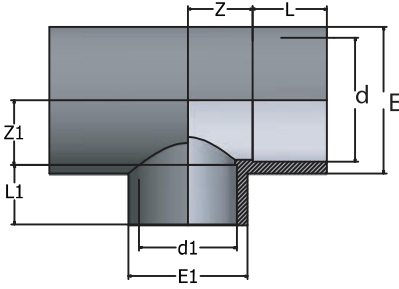

Code	dxd1	L	L1	Z	Z1	E	E1 class	Gr	Pack	Box
TR43N050B	1 1/2" X 1/2"	30	16.5	26	26	61	27 E	155	110	L
TR43N050C	1 1/2" X 3/4"	30	19.5	26	26	61	33 E	166	110	L
TR43N050D	1 1/2" X 1"	30	22.5	26	26	61	41 E	170	110	L
TR43N063C	2 X 3/4"	36	19.5	33	32.5	76	33 E	270	70	L
TR43N063D	2 X 1"	36	22.5	33	32.5	76	41 E	275	70	L
TR43N063F	2 X 1 1/2"	36	30	33	32.5	76	61 E	300	60	L
TR43N090F	3 X 1 1/2"	50.5	30	47	46	108	61 E	740	24	L
TR43N090G	3" X 2"	50.5	36	47	46	108	76 E	740	22	L
TR43N110F	4" X 1 1/2"	63	30	57	56	131	61 E	1250	12	L
TR43N110G	4" X 2"	63	36	57	56	131	76 E	1200	12	L

## ST23

STUB FLANGE BS

بردة

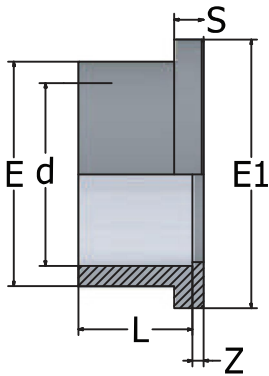

Code	d	L	Z	S	E	E1	Class	Gr	Pack	Box
ST23N0200	1/2"	16.5	3	6	27	34	E	10	550	S
ST23N0250	3/4"	19.5	3	6	33	41	E	14	350	S
ST23N0320	1"	22.5	3	6	41	50	E	23	200	S
ST23N0400	1 1/4"	26.6	3	8	50	61	E	48	250	M
ST23N0500	1 1/2"	30	3	8	61	73	E	68	180	M
ST23N0630	2"	36	3	8	76	90	E	128	90	M
ST23N0900	3"	50.5	5	10	108	125	E	272	70	L
ST23N1100	4"	63	5	11	131	150	E	361	45	L



## CA73

CAP BS

طبة

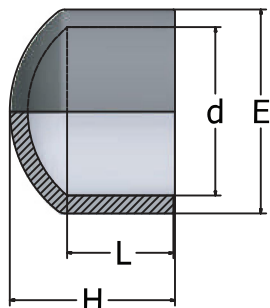

Code	d	L	H	E	class	Gr	Pack	Box
CA73N0200	1/2"	16	27	28	E	10	500	S
CA73N0250	3/4"	19	31	33	E	16	350	S
CA73N0320	1"	22	36	41	E	26	450	M
CA73N0400	1.1/4"	26	43	50	E	40	300	M
CA73N0500	1 1/2"	31	49	60.5	E	73	180	M
CA73N0630	2"	38	57	75	E	128	100	M
CA73N0750	2 1/2"	44	67	89	E	178	60	M
CA73N0900	3"	51	80	106	E	310	65	L
CA73N1100	4"	61	95	132	E	520	40	L

## UN83

UNION WITH O-RING BS

لاکور تجميع

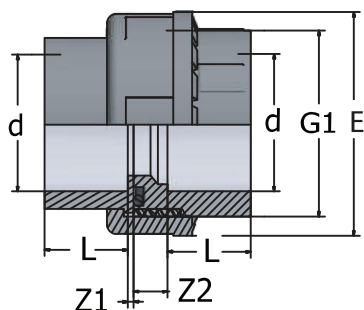

Code	d	L	Z1	Z2	G1	E	O-Ring	class	Gr	Pack	Box
UN83N0200	1/2"	16	3	10	1"	42	4081	E	41	180	S
UN83N0250	3/4"	19	3	10	1 1/4"	52	4112	E	67	220	M
UN83N0320	1"	22	3	10	1 1/2"	59	4131	E	90	130	M
UN83N0400	1 1/4"	26	3	12	2"	72	6162	E	135	80	M
UN83N0500	1 1/2"	31	3	14	2 1/4"	79	6187	E	206	120	L
UN83N0630	2"	38	3	18	2 3/4"	96	6237	E	360	60	L
UN83N0900	3"	51	5	18	4"	134	6362	E	777	24	L
UN83N1100	4"	61	5	18	5"	163	6450	E	1150	12	L

## EL54

90° ELBOW BS Plain/Threaded

كوع لصبق / سن 90°

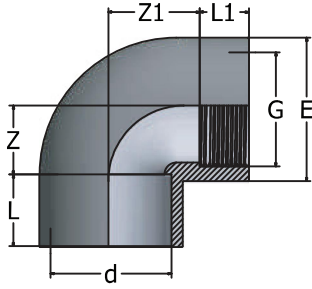

Code	dxG	L	L1	Z	Z1	E	Gr	Pack	Box
EL54N020B	1/2X1/2	16.5	15	11	12	27	15	300	S
EL54N025C	3/4X3/4	19.5	16	13.5	16	33	27	350	M
EL54N032D	1X1	22.5	19	17	20	41	48	200	M
EL54N040E	1 1/4x1 1/4	27	21	21	20	50	72	120	M
EL54N050F	1 1/2X1 1/2	30	21	26	28	61	162	140	L
EL54N063G	2X2	36	26	32.5	38	76	310	70	L

## SO14

FEMALE ADAPTOR

جلبة

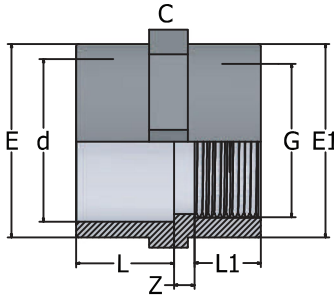

Code	dxG	L	L1	Z	E	E1	C	Gr	Pack	Box
SO14N020B	1/2"X1/2"	16.5	15	3	27	28	24	15	350	S
SO14N025C	3/4"X3/4"	19.5	16	3	33	34	30	22	250	M
SO14N032D	1"X1"	22.5	19	3	41	42	34	33	300	M
SO14N040E	1 1/4x1 1/4	27	21	3	51	50	42	63	180	M
SO14N050F	1 1/2"X1 1/2"	30	21	3	61	58	55	100	120	M
SO14N063G	2"X2"	36	26	3	76	72	65	158	75	M
SO14N090I	3"x3"	50	33	5	108	106	90	347	54	L
SO140110L	4"x4"	63	39	6	131	129	110	508	30	L

## TE44

90° TEE BS Plain/Threaded

مشترك لصبق / سن 90°

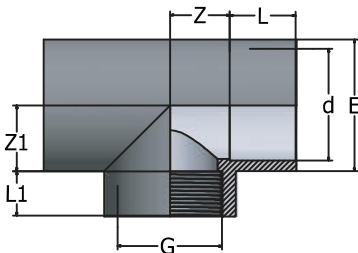

Code	dxG	L	L1	Z	Z1	E	Gr	Pack	Box
TE44N020B	1/2"x1/2"	16.5	15	11	12	27	25	200	S
TE44N025C	3/4"x3/4"	19.5	16	13.5	16	33	38	250	M
TE44N032D	1"x1"	22.5	19	17	20	41	69	130	M
TE44N040E	1 1/4x1 1/4	27	21	21	20	51	106	80	M
TE44N050F	1 1/2x1 1/2	30	21	26	28	61	213	90	L
TE44N063G	2"x2"	36	26	32.5	38	76	380	50	L



## AD14

### MALE THREADED ADAPTOR BS

رأس خط سن خارجي

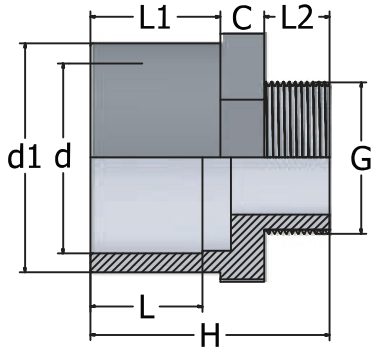

Code	dXd1XG	L	L1	L2	H	C	Gr	Pack	Box
AD14N020B	1/2"x3/4"x1/2"	16.5	19.5	15	46	27	15	350	S
AD14N025C	3/4"x1"x3/4"	19.5	22.5	16	50	36	27	450	M
AD14N032D	1"x1.1/4" x 1"	22.5	27	19	57	42	43	250	M
AD14N040F	1"1/4x1"1/2"x1"1/2"	27	30	21	67	55	64	140	M
AD14N050F	1.1/2" x2"x 1.1/2"	30	36	21	74	65	110	120	M
AD14N063G	2"x21/2"x2"	36	44	26	84	75	152	90	M
AD14N063H	2"x2"1/2x2"1/2"	36	44	30	91	80	180	90	L
AD14N090I	3" x 4" x 3"	51	63	33	113	119	578	45	L
AD14N110L	4" x 5" x 4"	63	69	39	120	130	426	30	L

## SO15

### ADAPTOR SOCKET

جلبية

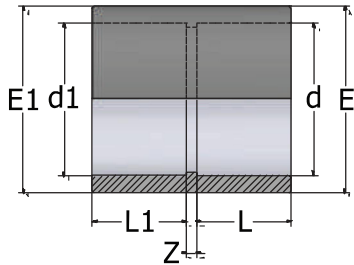

Code	dxd1	L1	L2	Z	E	E1	PN	Gr	Pack	Box
SO15N020B	20X1/2"	16	16.5	3	27	28	16	11	380	S
SO15N025C	25X3/4"	19	19.5	3	33	33	16	17	500	M
SO15N032D	32X1	22	22.5	3	41	41	16	27	300	M
SO15N040E	40X1.1/4"	26	27	3	50	50	16	45	200	M
SO15N050F	50X1.1/2"	31	30	3	61	61	16	64	220	L
SO15N063G	63X2"	38	36	3	76	76	16	109	125	L

## TR44

### 90° TEE REDUCED

مشترك مخفض

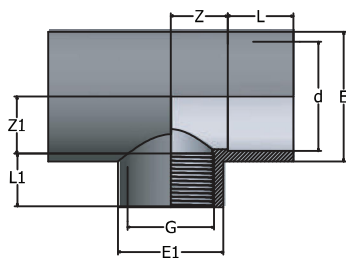

Code	dxG	L	L1	Z	Z1	E	E1	Gr	Pack	Box
TR44N032B	1" X 1/2"	22	16	17	12	41	27	10199	16	M
TR44N032C	1" X 3/4"	22	19.5	17	17	41	33	71745	14	M
TR44N050B	1.1/2"X1/2"	31	16	26	12	61	27	1562	110	L
TR44N050C	1.1/2" X3/4"	31	19.5	26	17	61	33	16774	110	L
TR44N063B	2" X 1/2"	38	16	32.5	12	76	33	2692	70	L
TR44N063C	2" X 3/4"	38	19.5	32.5	17	76	33	27174	70	L

# UPVC VALVES

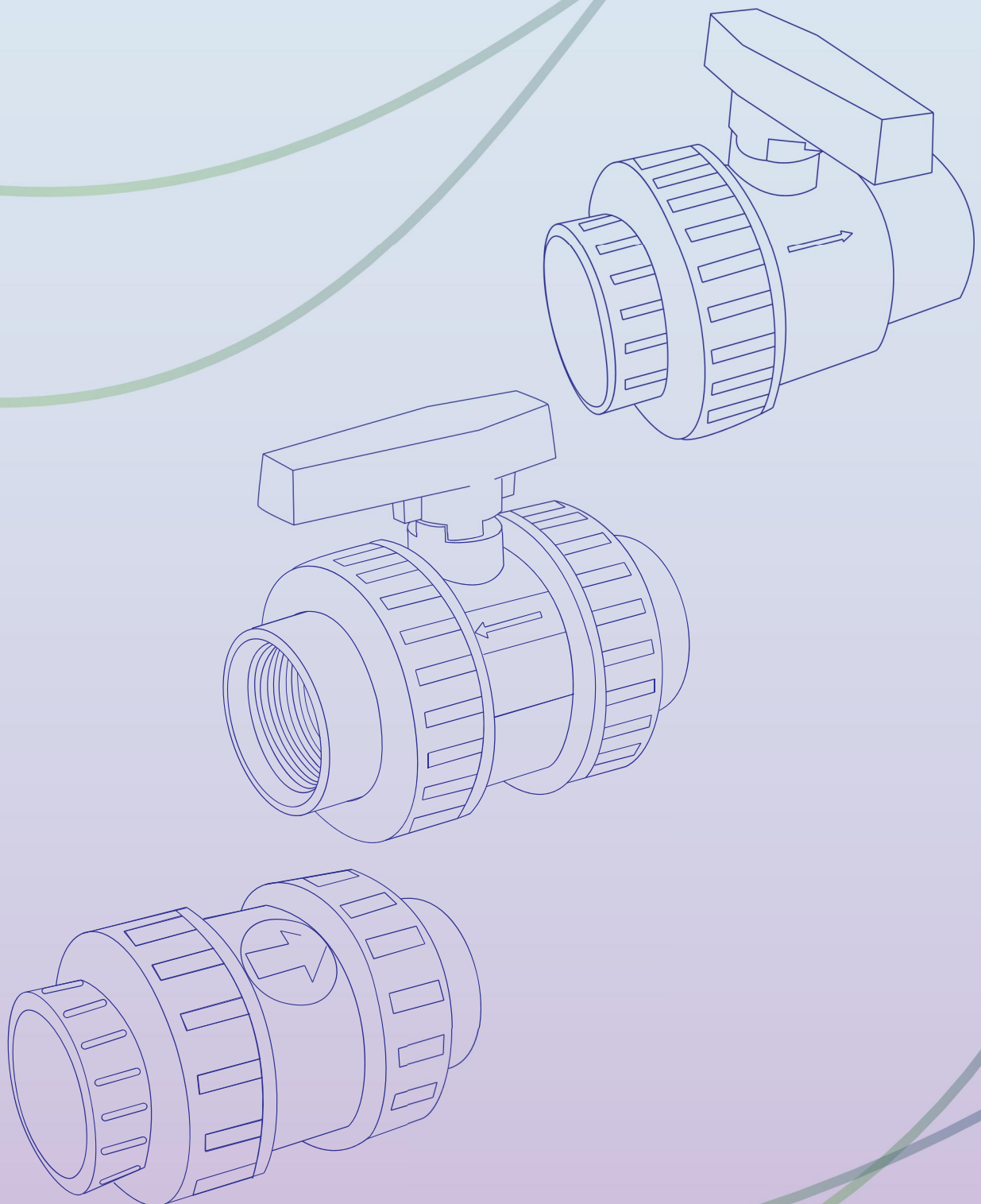



## Technical Data

### UPVC VALVES - General characteristics

---

Our compact type, double and single union ball valves are characterized by low torque and full bore, and can be used, where applicable, as end stop valves. These features make These Valves the obvious choice for use in water treatment swimming pools foodstuff and potable water systems and with non-reactive chemicals.

### Installation and use

---

When gluing the end connector on the pipe, care must be taken to prevent the glue or solvent from coming into contact with the valve seats or ball. Parallel threaded ends should not be connected with taper male heads and the use of hems or similar materials should be avoided. Special attention should be paid to the correct line-up of the installation and to the pipe length. Tighten the union nut hand-tight only. The use of a wrench is not recommended. It is important that the unions are not used to pull the system together. If there is any leakage from the union nuts, please check the correct line-up of the system and the pipe length. Excessive tightening of the union could break them. Before the valve is commissioned all dirt, sand or other material should be flushed from the system. This is to prevent scarring of the ball and/or seats. Avoid rapid closing / opening of the valve to eliminate the possibility of water hammer causing damage to the pipeline. It is important that all installation and maintenance personnel become familiar with the proper solvent cement and thread jointing procedures.

### Assembling & Disassembling instructions in case of maintenance

---

#### Double union BVD

The whole body of the valve can be removed from the installation by unscrewing the union nuts. To reach the internal parts of the valve, proceed as follows:

- A) Set the valve open.
- B) Remove the handle 1 from control stem 2
- C) Unscrew the sealing bush 7 off the body 3 using the two teeth (d) of the Handle 1 unscrewing operations should be done counter-clockwise.
- D) After having unscrewed the sealing bush 7 it is possible to dismantle all the internal parts of the valve and to check the O-rings. To remove the ball 6, turn the control stem 90° to the closed position. The ball can then be removed through the control stem 2. To remove the control stem push it downwards as far as possible. To reassemble the valve follows the instructions in reverse order, being careful to set the O-ring properly and grease it with silicone grease.

#### Single Union BVS

Positioning this valve in an installation, take care that it's not possible to remove it from the installation by unscrewing the union nut. To disassemble and reassemble the valve, follow the instructions of BVD version from point A to D.

\* All our check valves are manufactured to the same dimensions as our valves BVD 10/11/13 and can be removed from the installation by unscrewing the union nuts. Our whilst type CVD is a spring loaded check valve. Types FVD are foot valves, ARV is an air release valve.

Pressure Chart

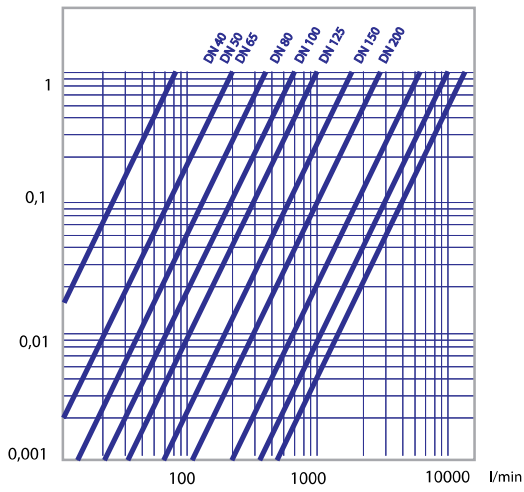

Working pressure

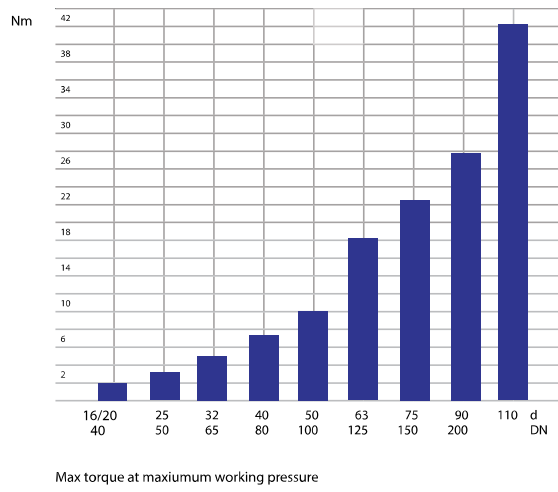

- Pressure/temperature rating for water and other suitable fluids to which PVC is Resistant.

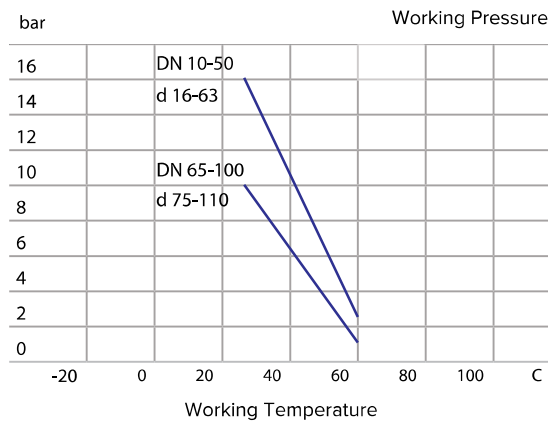

Flow Coefficient KV 100:

KV100 is the number of litres per minute of water at a temperature of 20 C that will flow through a valve with one-bar pressure differential at a specified rate, the kv100 valves shown in the table are calculated with the valve completely open.

d	16	20	25	32	40	50	63	75	90	110
DN	10	15	20	25	32	40	50	65	80	100
K <sub>v100</sub>	80	200	385	770	1100	1750	3400	5250	7100	9500

Valves certified according to EN 1267

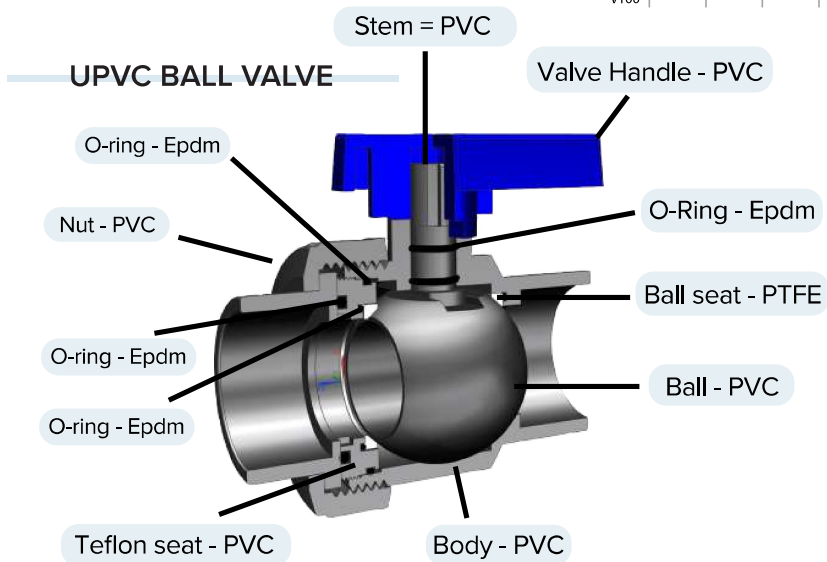



## UPVC BALL VALVE WITH SAFETY LOCK

Valves are factory readjusted with the new **SAFETY LOCK** to ensure the leak tightness and lock-out needs without tampering with the ball free movement.

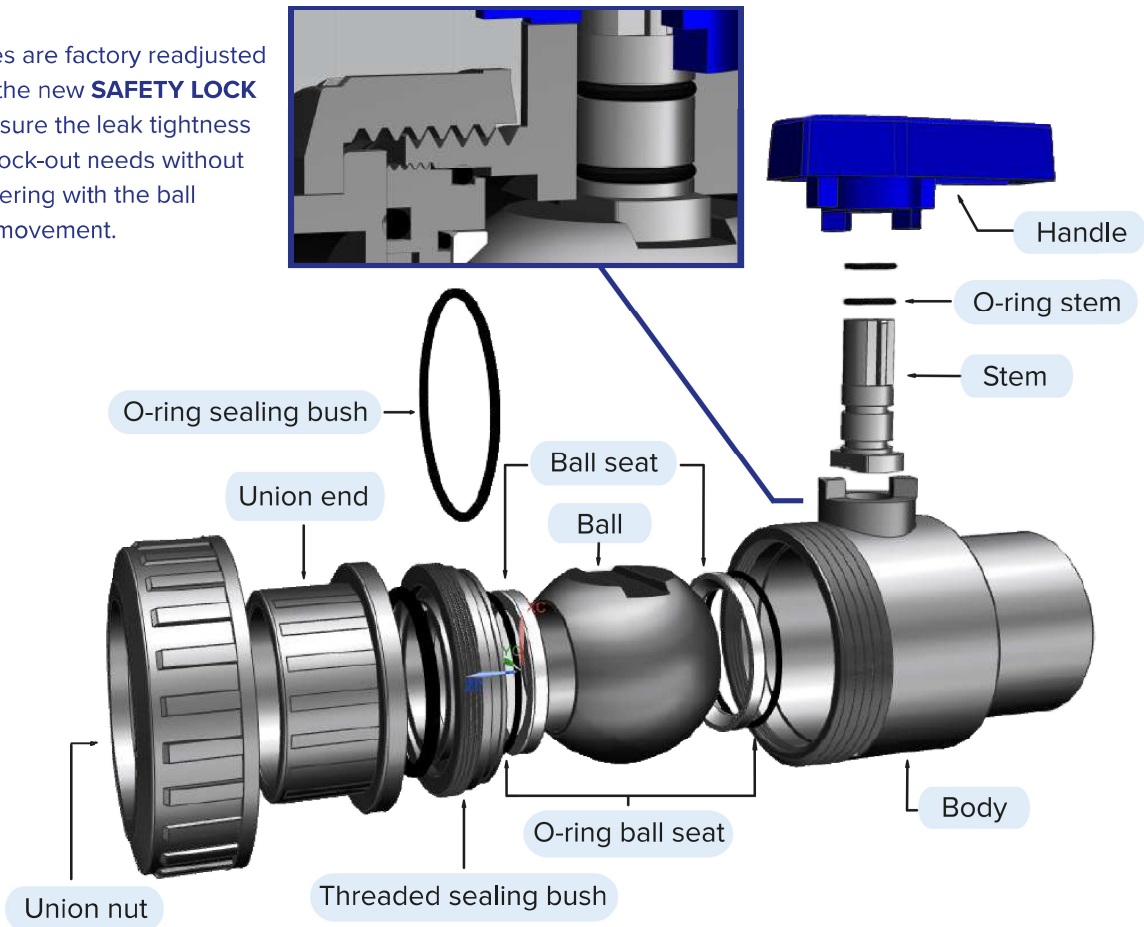

### BVSL15

Single union ball valve with male threaded ends

Code	G	DN	L	Z	H	A	B	C	E	F	PN
BVSL15N0320	1"	25	19.5	53	92	67	14	62	44	25	10

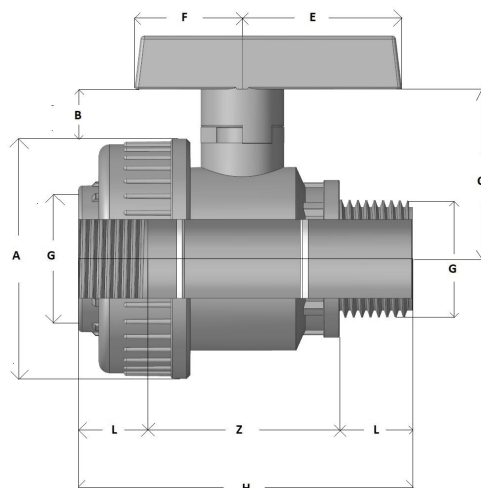

## BVSL 10

Single union ball valve  
with adjustable seat  
& female plain ends

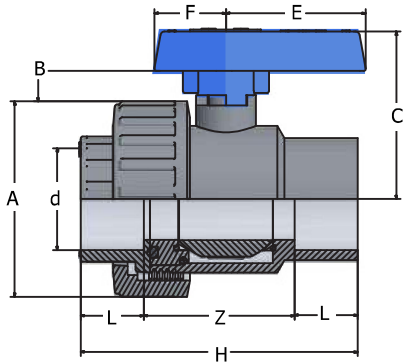

Pos.	Components	N°	Material	Pos.	Components	N°	Material
1	Handle	1	PVC	7	Support	1	PVC
2	Stem	1	PVC	8	Ball Seat	2	PTFE
3	Body	1	PVC	9	Union o-ring	2	EPDM
4	Union end	2	PVC	10	O-ring sealing bush	1	EPDM
5	Union Nut	2	PVC	11	O-ring ball seat	2	EPDM
6	Ball	1	PVC	12	O-ring stem	2	EPDM

d	DN	L	Z	H	A	B	C	E	F	PN	Gr
20	15	16	44	76	50	10	48	39	19	16	110
25	20	19	52	90	60	11	54	47	22	16	170
32	25	22	58	102	68	13	62	55	25	16	250
40	32	26	66	118	80	18	75	60	30	16	370
50	40	31	74	136	96	20	87	68	35	16	560
63	50	38	92	168	116	20	101	80	40	16	980
75	65	44	126	214	145	25	123	90	45	10	1825
90	80	51	138	240	166	28	138	100	50	10	2900
110	100	61	153	275	210	28	160	120	60	10	4790

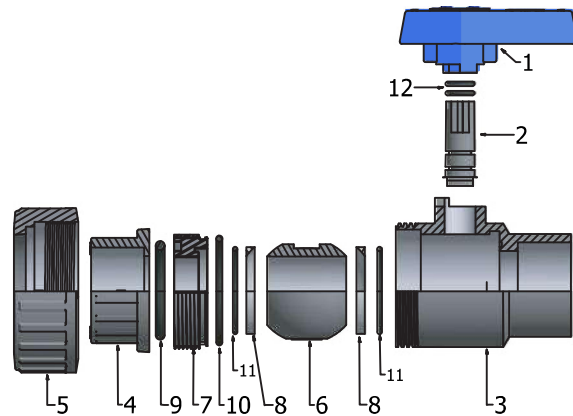

## BVSL 11

Single union ball valve  
with adjustable seat &  
female threaded ends

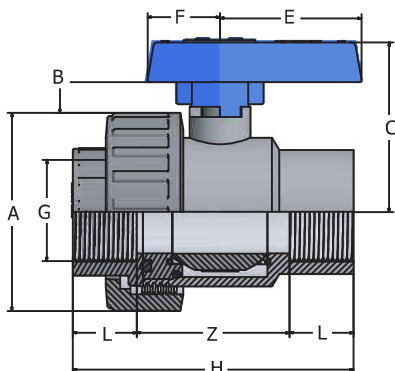

Pos.	Components	N°	Material	Pos.	Components	N°	Material
1	Handle	1	PVC	7	Support	1	PVC
2	Stem	1	PVC	8	Ball Seat	2	PTFE
3	Body	1	PVC	9	Union o-ring	2	EPDM
4	Union end	2	PVC	10	O-ring sealing bush	1	EPDM
5	Union Nut	2	PVC	11	O-ring ball seat	2	EPDM
6	Ball	1	PVC	12	O-ring stem	2	EPDM

G	DN	L	Z	H	A	B	C	E	F	PN	Gr
1/2"	15	16	44	76	50	10	48	39	19	16	110
3/4"	20	19	52	90	60	11	54	47	22	16	170
1"	25	22	58	102	68	13	62	55	25	16	250
1 1/4"	32	26	66	118	80	18	75	60	30	16	370
1 1/2"	40	31	74	136	96	20	87	68	35	16	580
2"	50	38	92	168	116	20	101	80	40	16	1030
2 1/2"	65	44	126	214	145	25	123	90	45	10	1870
3"	80	51	138	240	166	28	138	100	50	10	2950
4"	100	61	153	275	210	28	160	120	60	10	4850

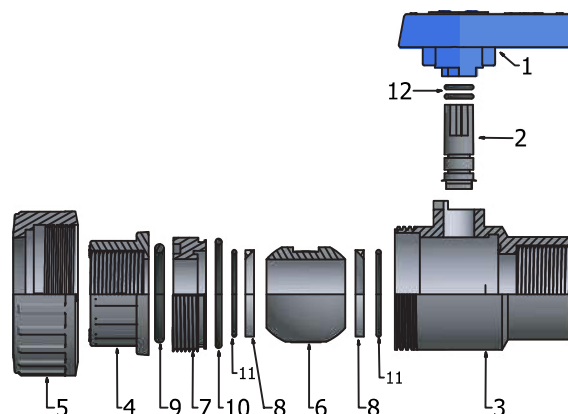



## BVDL 10

Double union ball valve  
with adjustable seat &  
female plain ends

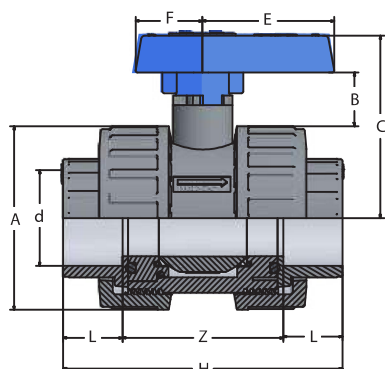

Pos.	Components	N°	Material	Pos.	Components	N°	Material
1	Handle	1	PVC	7	Sealing Bush	1	PVC
2	Stem	1	PVC	8	Ball Seat	2	PTFE
3	Body	1	PVC	9	Union o-ring	2	EPDM
4	Union end	2	PVC	10	O-ring sealing bush	1	EPDM
5	Union Nut	2	PVC	11	O-ring ball seat	2	EPDM
6	Ball	1	PVC	12	O-ring stem	2	EPDM

d	DN	L	Z	H	A	B	C	E	F	PN	Gr
20	15	16	49	81	50	10	48	39	19	16	130
25	20	19	56	94	60	11	54	47	22	16	210
32	25	22	63	107	68	13	62	55	25	16	310
40	32	26	72	124	80	18	75	60	30	16	450
50	40	31	84	146	96	20	87	68	35	16	700
63	50	38	94	170	116	20	101	80	40	16	1180
75	65	44	130	218	145	25	123	90	45	10	2260
90	80	51	148	250	166	28	138	100	50	10	3520
110	100	61	168	290	210	28	160	120	60	10	5830

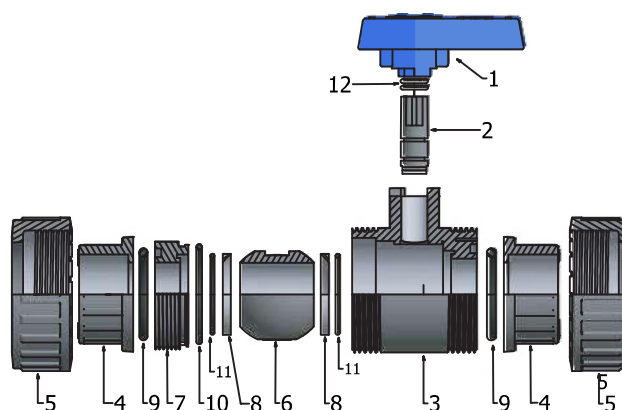

## BVDL 11

Double union ball valve  
with adjustable seat &  
female threaded ends

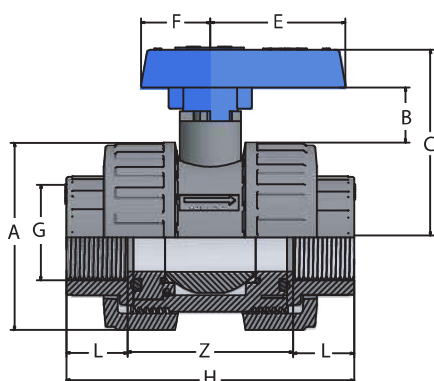

Pos.	Components	N°	Material	Pos.	Components	N°	Material
1	Handle	1	PVC	7	Sealing Bush	1	PVC
2	Stem	1	PVC	8	Ball Seat	2	PTFE
3	Body	1	PVC	9	Union o-ring	2	EPDM
4	Union end	2	PVC	10	O-ring sealing bush	1	EPDM
5	Union Nut	2	PVC	11	O-ring ball seat	2	EPDM
6	Ball	1	PVC	12	O-ring stem	2	EPDM

d	DN	L	Z	H	A	B	C	E	F	PN	Gr
1/2"	15	16	49	81	50	10	48	39	19	16	130
3/4"	20	19	56	94	60	11	54	47	22	16	210
1"	25	22	63	107	68	13	62	55	25	16	310
1 1/4"	32	26	72	124	80	18	75	60	30	16	450
1 1/2"	40	31	84	146	96	20	87	68	35	16	730
2"	50	38	94	170	116	20	101	80	40	16	1220
2 1/2"	65	44	130	218	145	25	123	90	45	10	2300
3"	80	51	148	250	166	28	138	100	50	10	3650
4"	100	61	168	290	210	28	160	120	60	10	6000

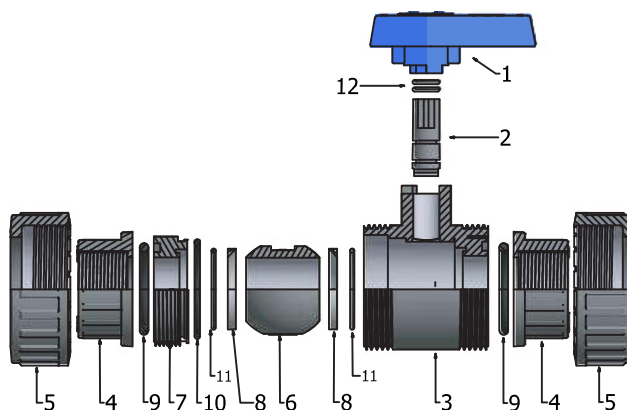

## BVSL 13

Single union ball valve  
with adjustable seat &  
BS male plain ends

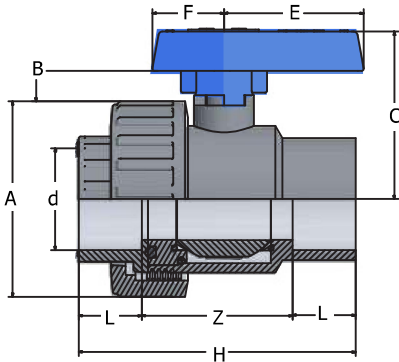

Pos.	Components	N°	Material	Pos.	Components	N°	Material
1	Handle	1	PVC	7	Support	1	PVC
2	Stem	1	PVC	8	Ball Seat	2	PTFE
3	Body	1	PVC	9	Union o-ring	2	EPDM
4	Union end	2	PVC	10	O-ring sealing bush	1	EPDM
5	Union Nut	2	PVC	11	O-ring ball seat	2	EPDM
6	Ball	1	PVC	12	O-ring stem	2	EPDM

d	DN	L	Z	H	A	B	C	E	F	Class	PN	Gr
½"	15	16	44	76	50	10	48	39	19	E	16	105
¾"	20	19	52	90	60	11	54	47	22	E	16	170
1"	25	22	58	102	68	13	62	55	25	E	16	250
1¼"	32	26	66	118	80	18	75	60	30	E	16	370
1½"	40	31	74	136	96	20	87	68	35	E	16	448
2"	50	38	92	168	116	20	101	80	40	E	16	784
2½"	65	44	126	214	145	25	123	90	45	D	16	1460
3"	80	51	133	240	166	28	138	100	50	D	10	2320
4"	100	61	153	275	210	28	160	120	60	D	10	3832

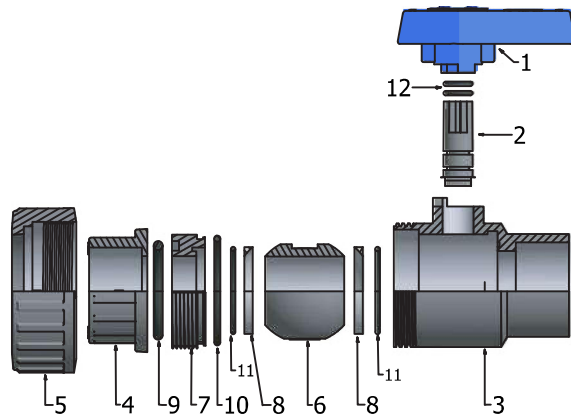

## BVDL 13

Double union ball valve  
with adjustable seat &  
BS female plain ends

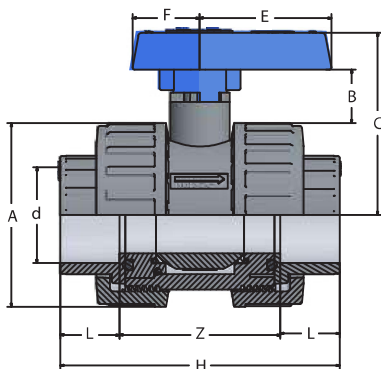

Pos.	Components	N°	Material	Pos.	Components	N°	Material
1	Handle	1	PVC	7	Support	1	PVC
2	Stem	1	PVC	8	Ball Seat	2	PTFE
3	Body	1	PVC	9	Union o-ring	2	EPDM
4	Union end	2	PVC	10	O-ring sealing bush	1	EPDM
5	Union Nut	2	PVC	11	O-ring ball seat	2	EPDM
6	Ball	1	PVC	12	O-ring stem	2	EPDM

D	DN	L	Z	H	A	B	C	E	F	Class	PN	Gr
½"	15	16	49	81	50	10	48	39	19	E	16	130
¾"	20	19	56	94	60	11	54	47	22	E	16	200
1"	25	22	63	107	68	13	62	55	25	E	16	295
1¼"	32	26	72	124	80	18	75	60	30	E	16	440
1½"	40	31	84	146	96	20	87	68	35	E	16	720
2"	50	38	94	170	116	20	101	80	40	E	16	1190
2½"	65	44	130	218	145	25	123	90	45	D	16	2210
3"	80	51	148	290	166	28	138	100	50	D	10	3520
4"	100	61	168	290	210	28	160	120	60	D	10	5150

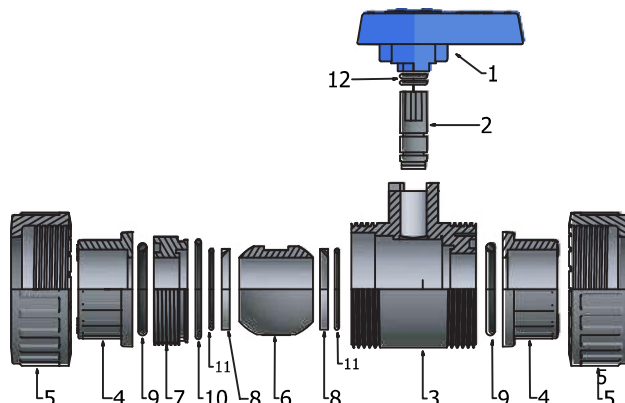



## CVD 10

Check valve with female sockets for solvent welding

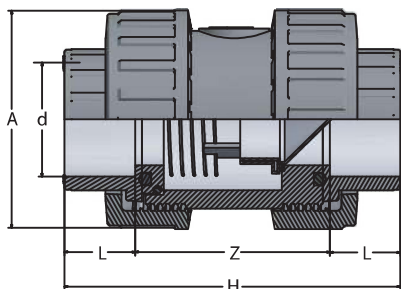

Pos.	Components	N°	Material
1	Body	1	PVC
2	Shutter	1	PVC
3	Sealing bush	1	PVC
4	union	2	PVC
5	Union but	2	PVC
6	Gasket	1	EPDM
7	Union O-ring	2	EPDM
8	O-ring	1	EPDM
9	Spring	1	INOX

d	DN	L	Z	H	A	PN	Gr
20	15	16	49	81	50	16	110
25	20	19	56	94	60	16	170
32	25	22	63	107	68	16	250
40	32	26	72	124	80	16	370
50	40	31	84	146	96	16	560
63	50	38	94	170	116	16	980
75	65	44	130	218	145	10	1740
90	80	51	148	250	166	10	2770
110	100	61	168	290	210	10	4740

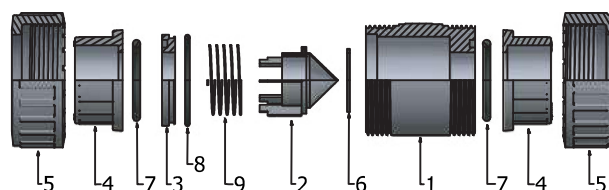

## CVD 11

Check valve female with female threaded sockets

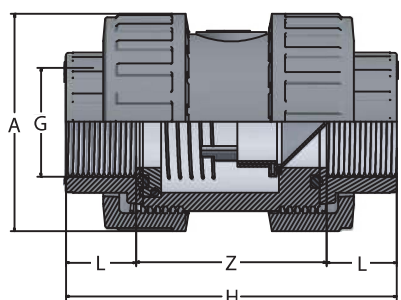

Pos.	Components	N°	Material
1	Body	1	PVC
2	Shutter	1	PVC
3	Sealing bush	1	PVC
4	union	2	PVC
5	Union but	2	PVC
6	Gasket	1	EPDM
7	Union O-ring	2	EPDM
8	O-ring	1	EPDM
9	Spring	1	INOX

G	DN	L	Z	H	A	PN	Gr
1/2"	15	16	49	81	50	16	110
3/4"	20	19	56	94	60	16	170
1"	25	22	63	107	68	16	250
1 1/4"	32	26	72	124	80	16	370
1 1/2"	40	31	84	146	96	16	560
2"	50	38	94	170	116	16	980
2 1/2"	65	44	130	218	145	10	1740
3"	80	51	148	250	166	10	2770
4"	100	61	168	290	210	10	4740

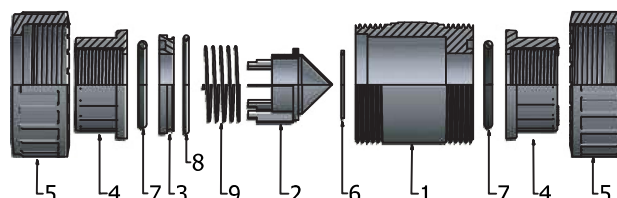

Minimum pressure drop in the fully open position

d	20	25	32	40	50	63	75	90	110
R	1 1/2"	3/4"	1"	1 1/4"	1 1/2"	2"	2 1/2"	3"	4"
bar	0.010	0.010	0.015	0.015	0.020	0.020	0.030	0.030	0.030

Minimum back pressure for tight service (valve in closed position)

d	20	25	32	40	50	63	75	90	110
R	1 1/2"	3/4"	1"	1 1/4"	1 1/2"	2"	2 1/2"	3"	4"
bar	0.010	0.010	0.015	0.015	0.020	0.020	0.030	0.030	0.030

## CVD13

Check valve with BS female socket for solvent welding

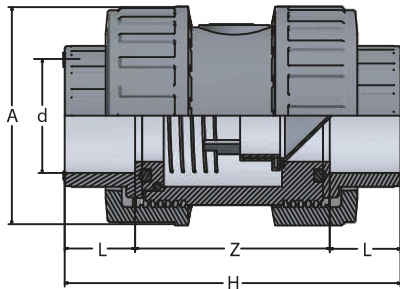

Pos.	Components	N°	Material
1	Body	1	PVC
2	Shutter	1	PVC
3	Sealing bush	1	PVC
4	union	2	PVC
5	Union but	2	PVC
6	Gasket	1	EPDM
7	Union O-ring	2	EPDM
8	O-ring	1	EPDM
9	Spring	1	INOX

d	DN	L	Z	H	A	PN	Gr
1/2"	15	16	49	81	50	16	110
3/4"	20	19	56	94	60	16	168
1"	25	22	63	107	68	16	246
1 1/4"	32	26	72	124	80	16	360
1 1/2"	40	31	84	146	96	16	552
2"	50	38	94	170	116	16	931
2 1/2"	65	44	130	218	145	10	1740
3"	80	51	148	250	166	10	2810
4"	110	61	168	290	210	10	4690

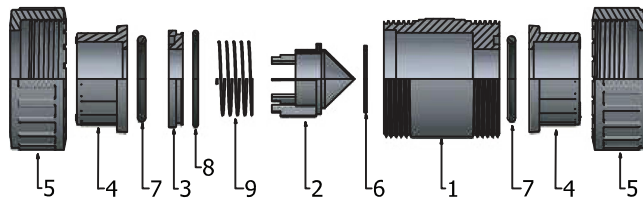

## CVDC10

Check ball valve with transparent body

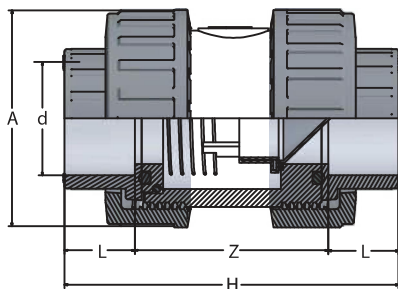

d	DN	L	Z	H	A	PN	Gr
20	15	16	49	81	50	16	110
25	20	19	56	94	60	16	170
32	25	22	63	107	68	16	250
40	32	26	72	124	80	16	370
50	40	31	84	146	96	16	560
63	50	38	94	170	116	16	980
75	65	44	130	218	145	10	1740
90	80	51	148	250	166	10	2770
110	100	61	168	290	210	10	4740

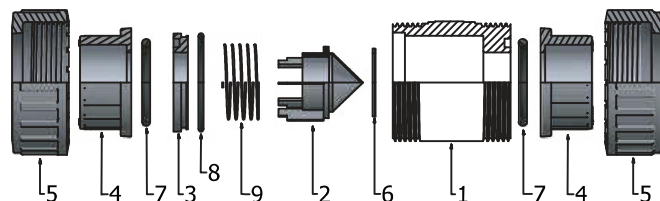

Pos.	Components	N°	Material
1	Body	1	Polycarbonate
2	Shutter	1	PVC
3	Sealing bush	1	PVC
4	union	2	PVC
5	Union but	2	PVC
6	Gasket	1	EPDM
7	Union O-ring	2	EPDM
8	O-ring	1	EPDM
9	Spring	1	INOX





## — Compression Valves —

- Our UPVC Ball Valve has been transformed with compression fitting junction to connect PE ISO metric pipes from both sides.
- Operating pressure: PN16 @ 20 °C

No.	Components	Material
1	Handle	UPVC
2	Nut	PP.B
3	Clinching Ring	POM
4	Push Ring	PP.B
5	O-Ring	EPDM
6	Body	UPVC

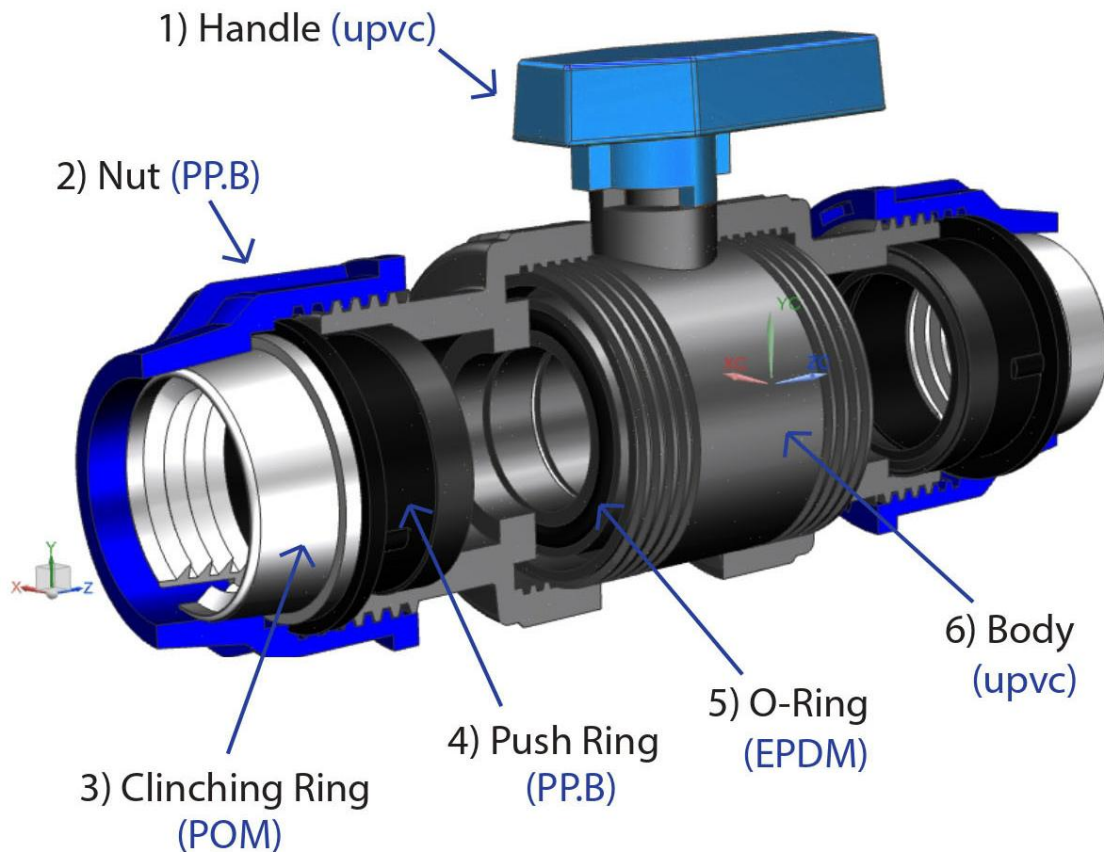
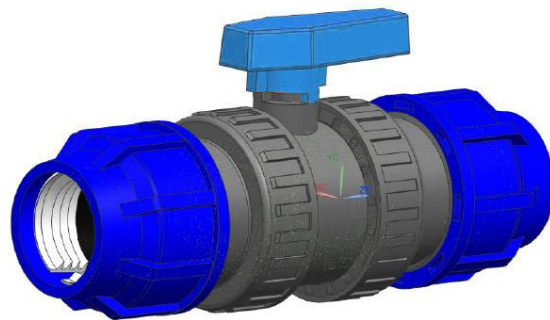

## BVSL19

Single union ball valve  
with quick coupling for P.E



Code	G x D	DN	L	L1	Z	H	A	B	C	E	F	PN	Gr
BVSL19N025C	3/4" x 25	20	62.5	19	67	148.5	60	11	54	47	22	16	
BVSL19N032D	1" x 32	25	60	22	61	143	67	14	62	55	25	16	300
BVSL19N050F	1.1/2" x 50	40	94	31	75	200	94	20	87	68	35	16	760
BVSL19N063G	2" x 63	50	106	38	96	240	112	20	101	80	40	16	1280

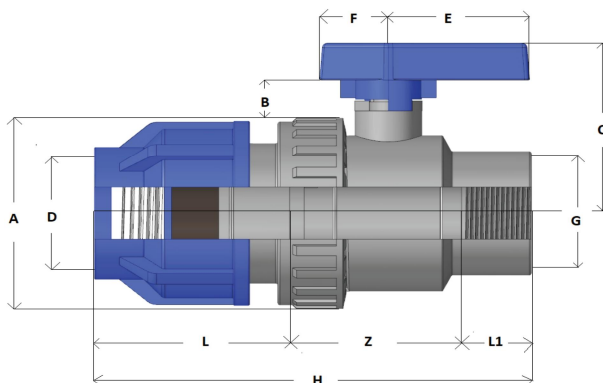

## BVDL19

Double union ball valve  
with quick coupling for P.E



Code	D	DN	L	Z	H	A	B	C	E	F	PN	Gr
BVDL19N0250	25 mm	20	62.5	83	208	60	11	54	47	22	16	
BVDL19N0320	32 mm	25	60	65	185	67	14	62	55	25	16	390
BVDL19N0500	50 mm	40	94	83	271	94	20	87	68	35	16	1070
BVDL19N0630	63 mm	50	106	102	314	112	20	101	80	40	16	1720

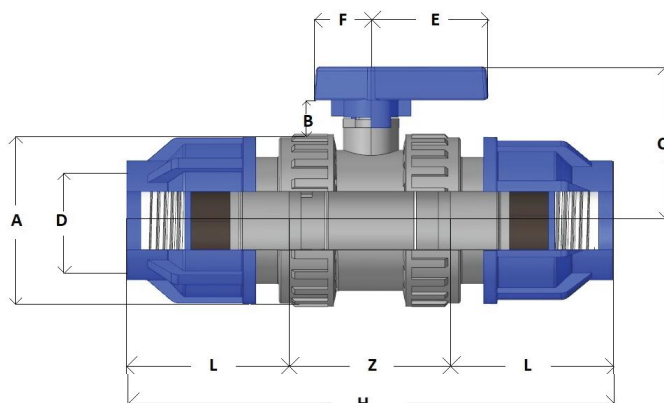





## BVSL17

Single union ball valve with male threaded ends / quick coupling for P.E



Code	G x D	DN	L	L1	Z	H	A	B	C	E	F	PN
BVSL17N025C	3/4" x 25	20	62.5	16	71	149.5	67	13.5	62	29.5	43	10
BVSL17N032D	1" x 32	25	60.5	20	59	139.5	68	13	62	29.5	43	10

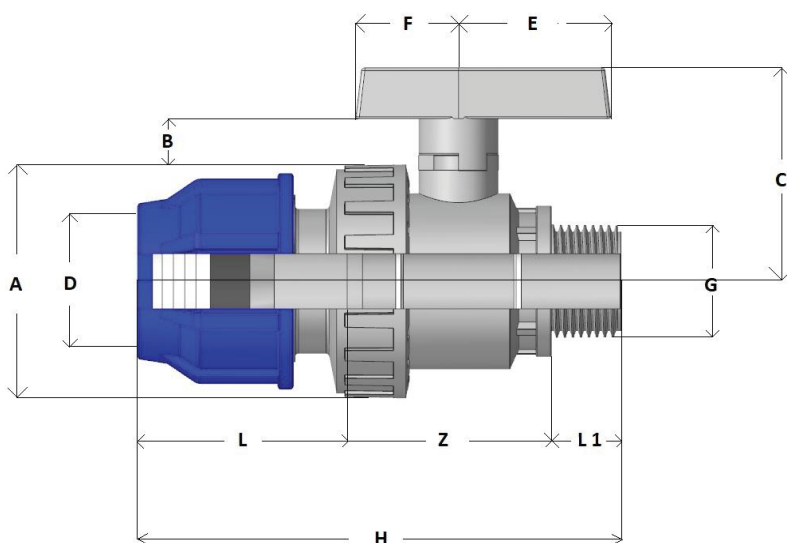

## FLAP VALVE

D		C		H		E		M x L	
mm	mm	"	mm	"	mm	"	mm	mm	"
63 / 2"	32	1.24	20	0.78	109	4.25	16x120	0.63x4.72	
75 / 2 1/2"	40	1.57	20	0.79	129	5.08	16x120	0.63x4.72	
90 / 3"	52	2.05	20	0.79	144	5.67	16x120	0.63x4.72	
110 / 4 1/2"	70	2.76	22	0.87	164	6.46	16x120	0.63x4.72	
125 / 4"	83	3.27	25	0.98	170	6.69	16x130	0.63x5.12	
140 / 5"	92	3.62	24	0.94	195	7.68	16x130	0.63x5.12	
160 / 6"	112	4.41	26	1.02	220	8.66	20x160	0.79x6.30	
200 / 7"	139	5.47	28	1.10	247	9.72	20x160	0.79x6.30	
225 / 8"	150	5.91	34	1.34	275	10.83	20x160	0.79x6.30	

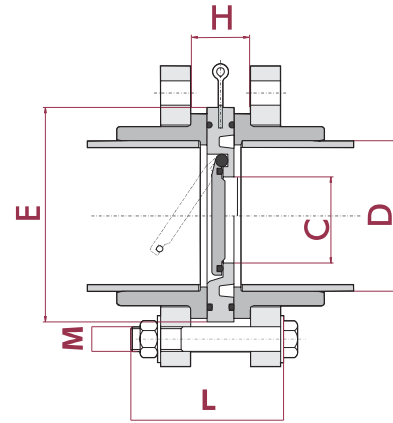

### Characteristics

Sizes	Metric flanges D63 - D315 (DN75 - DN225)	
Standards	ISO/DIN ASTM - 4" - 12"	EN 558-1 ANSI B.16.5 cl.150
Working pressure	20 <sup>0</sup> (73 <sup>0</sup> F) D75 - D225 (2"- 12"): PN 6 (90 psi)	
Minimum return pressure	<b>0,1 - 0,3 bar</b> Minimal downstream pressure to keep the valve closed, depending on installation conditions.	
Materials	O-rings: EPDM	
Characteristics	<ul style="list-style-type: none"> <li>- Requires little space in piping systems.</li> <li>- Easy installation: wafer body slips between standard flanges. No gaskets required</li> <li>- Vertical and horizontal operation.</li> <li>- Excellent flow characteristics.</li> </ul> <p>Do not install the valve at a distance lower than 5 x D of the pump out. Install with pipe DIN PN 10. In case of PN 16, the valve could be damaged.</p>	



## Components & Material

Components	Material
1) Body	PVC-U
2) Flap	PVC-U
3) Cap	PP
4) Body O-Ring	EPDM/ FPM
5) Flap O-Ring	EPDM/ FPM

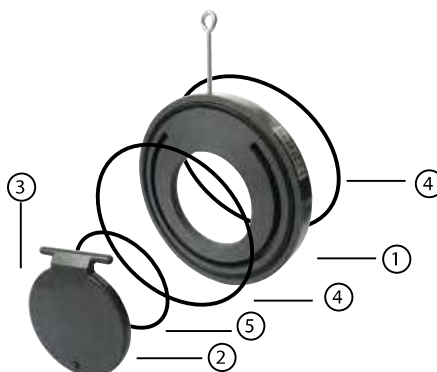

## Installation

- Install with flanges and PN 10 pipe.
- Do not install the valve at a distance lower than 5xD of the pump out.
- The valve must be installed in vertical horizontal pipework.
- On horizontal pipework the flange hinge must be at the top.
- Ensure the direction of flow is in accordance with the arrow on the valve body.
- Use the centralising screw to ensure the valve is positioned centrally in the flanges.
- **WARNING:** To ensure the valves work correctly, the stub flanges must be perfectly lined up.

## PRESSURE / TEMPERATURE GRAPH

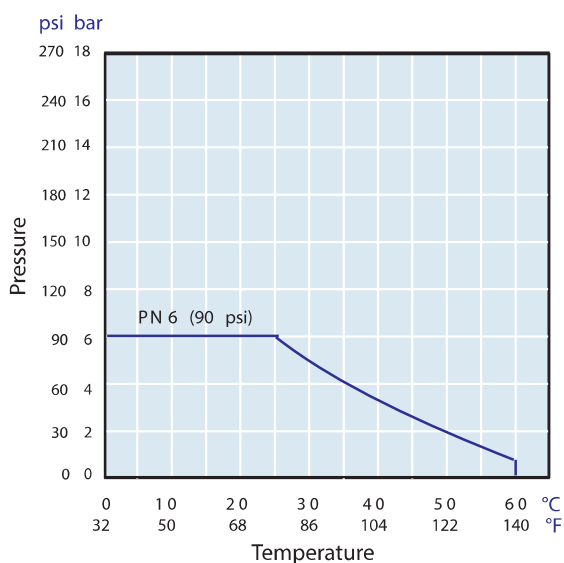

## PRESSURE LOSS DIAGRAM

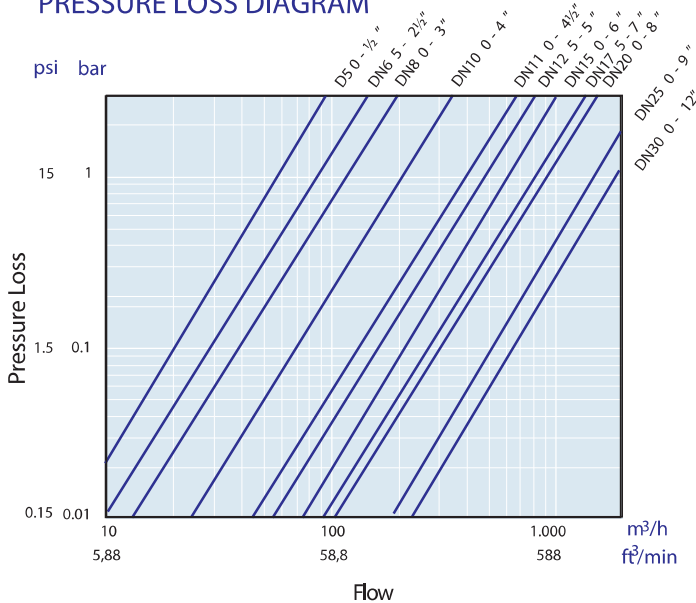

## RELATIVE FLOW

D	63	75	90	110	125	140	160	200	225
DN	50	65	80	100	125	125	150	175	200
Kv <sub>100</sub>	57	85	130	200	390	480	600	800	900
Cv	4,0	6,0	9,1	14,0	27,3	33,6	42,0	56,0	63,0

$C_v = K_{v100} / 14,28$   
 $K_{v100}$  (l/min,  $\Delta p = 1$  bar)  
 $C_v$  (GPM,  $\Delta p = 1$  psi)

## UPVC VALVE SADDLE

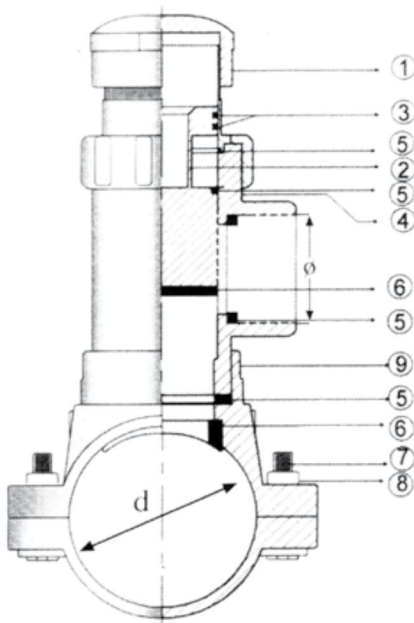

Pos.	Name	NO.	Material
1	CAP	1	U PVC
2	INSIDE PART	1	U PVC
3	OIL SEAL	2	EPDM
4	VALVE BODY	1	U PVC
5	O.RING	4	EPDM
6	SPECIAL GASKET	2	EPDM
7	BOLT	4	STAINLESS STEEL
8	NUT	4	STAINLESS STEEL
9	SADDLE	1	U PVC

### Installation Instructions:

- Set the saddle gasket in its groove before installing on the upper part of the pipe and assemble the upper and lower parts by the 4 bolts and nuts.
- Make a hole in the pipe and be sure to disconnect the water supply during assembling.
- This will take a few minutes; connect the valve body with the saddle.  
Note: make sure all O-rings are installed.
- After installing all parts, install the cap on the top of the valve saddle to save it from dust.

### Advantages:

- Neisco Valve Saddle can be installed at any level underground surface and open or close the valve from the surface with a special key.
- Neisco Valve Saddle is easy to assemble and disassemble for maintenance and all spare parts are available and can be installed on PE/UPVC pipes.
- The Valve Saddle is chemical resistant and it's bolts and nuts are made of stainless-steel.
- The upper part (valve body) can rotate to reach any house connection up to angle 45.
- Neisco Valve Saddle is made in Egypt with Italian experience; it's working pressure is 10 bar, test pressure is 15 bar, & factory test is 25 bar.

dxG	d	Ø
VS 75 10 PVC	75	1"
VS 75 20 PVC	75	2"
VS 75 32 PVC	75	32 mm
VS 75 63 PVC	75	63 mm
VS 90 10 PVC	90	1"
VS 90 20 PVC	90	2"
VS 90 32 PVC	90	32 mm
VS 90 63 PVC	90	63 mm
VS 110 10 PVC	110	1"
VS 110 20 PVC	110	2"
VS 110 32 PVC	110	32 mm
VS 110 63 PVC	110	63 mm
VS 125 10 PVC	125	1"
VS 125 20 PVC	125	2"
VS 125 32 PVC	125	32 mm
VS 125 63 PVC	125	63 mm
VS 160 10 PVC	160	1"
VS 160 20 PVC	160	2"
VS 160 32 PVC	160	32 mm
VS 160 63 PVC	160	63 mm
VS 200 10 PVC	200	1"
VS 200 20 PVC	200	2"
VS 200 32 PVC	200	32 mm
VS 200 63 PVC	200	63 mm
VS 225 10 PVC	225	1"
VS 225 20 PVC	225	2"
VS 225 32 PVC	225	32 mm
VS 225 63 PVC	225	63 mm

# BUTTERFLY VALVES

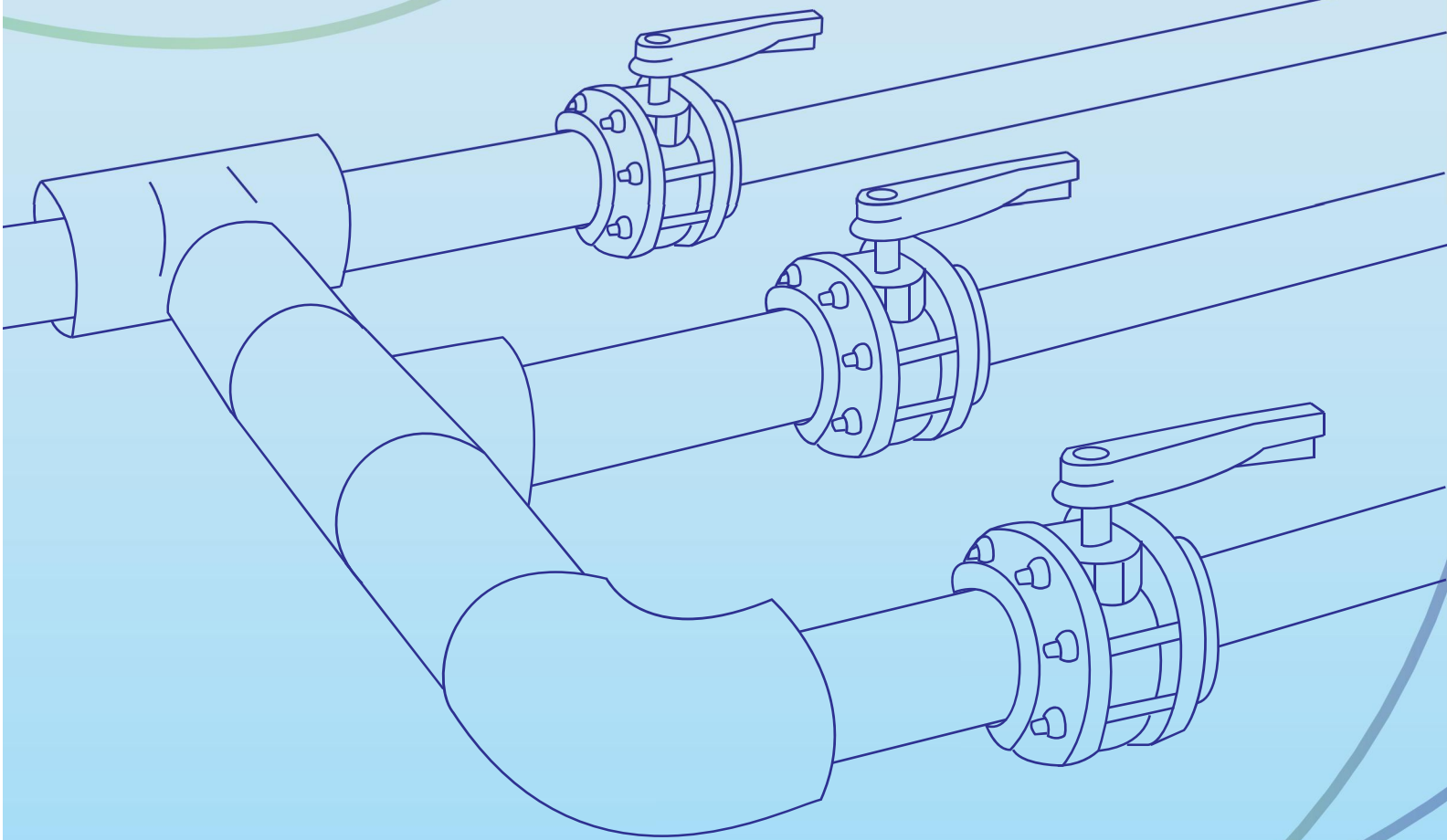



## Technical Data

### BUTERFLY VALVE - General characteristics

- Our butterfly valve is for shutting off or regulating flow specifically designed for water applications.
- Disk in PVC-U with through shaft
- Zinc plated square section steel stem completely isolated from the fluid complying with standard ISO 5211: DN 80 - 100 (14 mm)
- Can also be installed as an end line valve, bottom discharge valve or tank dump valve.
- Valve material compatability;  
water and other food substances according to possibility of directly installing a gearbox of pneumatic and/or electric actuators with a standard drilling pattern according to standard ISO 5211 FO5, FO7, F10.

Technical Specifications	
Construction	Centric butterfly valve
Size range	DN 80 - 100
Nominal pressure	Wafer version DN 80 - DN 100      PN 16 with water at 20°C
Temperature range	0°C - 60°C
Reference standards	Flanging system: EN ISO 1452, EN ISO 15493, DIN 2501 ISO 7005-1, EN 1092-1, ANSI B16.5 CI.150
Reference standards	Construction criteria: EN ISO 16136, EN ISO 1452, EN ISO 15493
	Test methods and requirements: ISO 9393
	Actuator couplings: ISO 5211
Valve material	Body and disk: PVC-UH Stem: Zinc plated carbon steel (C37) On request STAINLESS steel AISI 316
Seal material	Liner: EPDM - WRAS Approved
Control options	Hand lever operated; Gearbox, pneumatic actuator, electric actuator

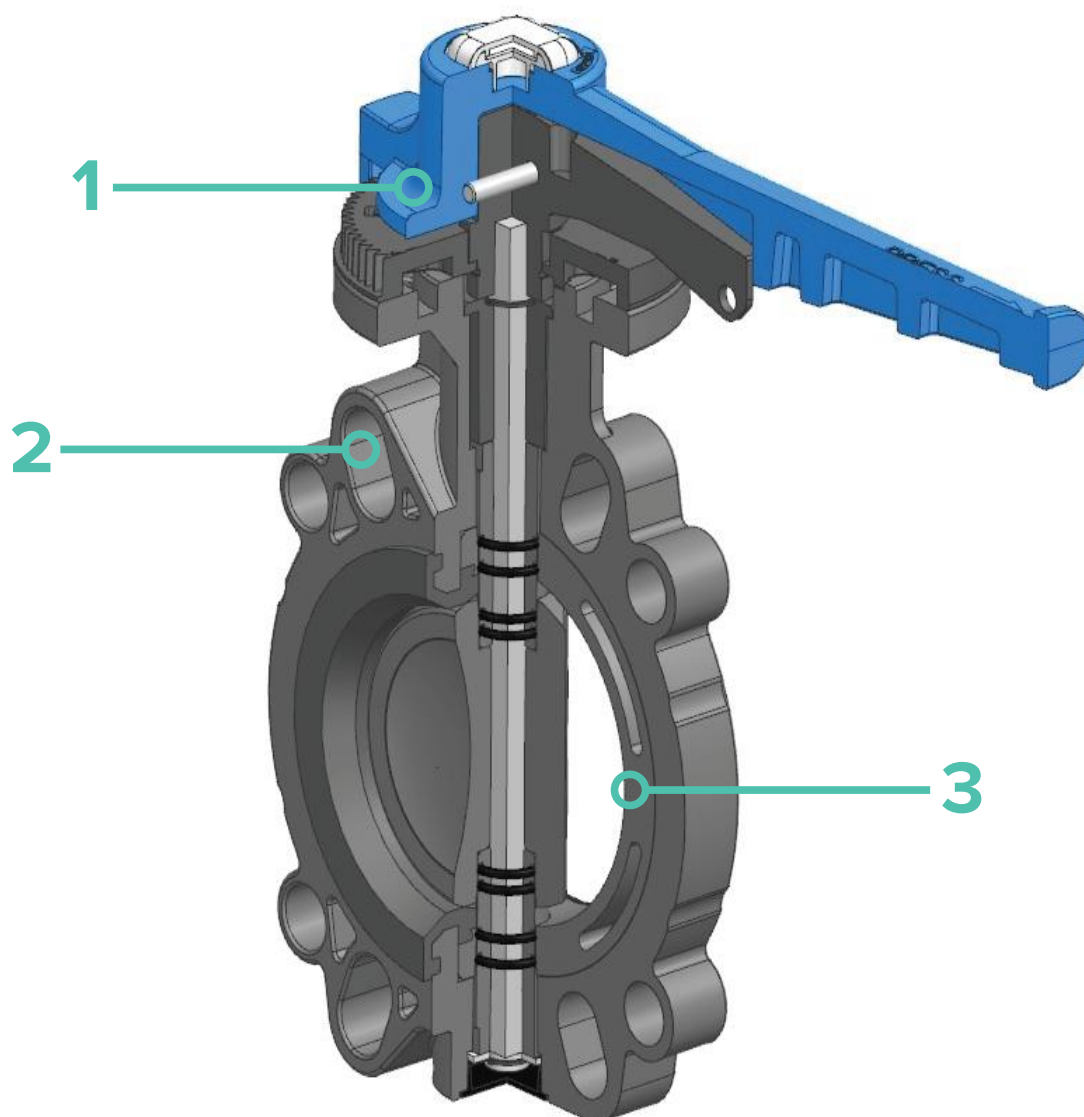

**1** Ergonomic multifunctional handle in HIPVC with the option for quick operation, graduated adjustment in 9 positions (every 10°)

**2** Drilling pattern with oval slots that allow coupling to flanges according to numerous international standards.

**3** Interchangeable liner with the dual function of forming a hydraulic seal and isolating the body from the fluid.



## Flow coefficient (KV)

DN	KV
80	251 m <sup>3</sup> /h
100	560 m <sup>3</sup> /h

## How to assemble the butterfly valve:

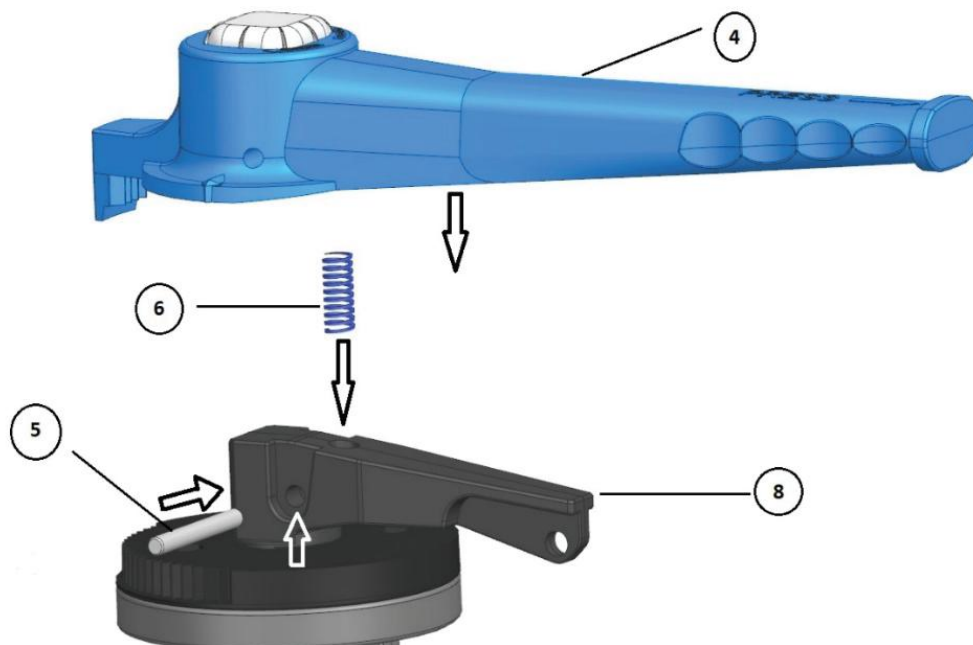

- Insert the metal spring (part #6) in it's designated place shown (part #8)
- Place the valve handle (part #4) in it's designated place shown (part #8)
- Insert the handle stem (part #5) while gently pushing on the handle downward so you can connect the handle (part #4) with (part #8) using the stem.





### Actuation

NEISCO Butterfly valve can be actuated with standard electric or pneumatic actuators and can be equipped with wheel gearboxes. The mounting flange is drilled according to standard ISO 5211.

#### Dimensions of the bolts to be used in installation

DN	ISO 5211	A	D	Q	H
80	F07	70	9	14	16
100	F07	70	9	14	16

DN	ISO 5211	A	D
80	F07	70	9
100	F07	70	9

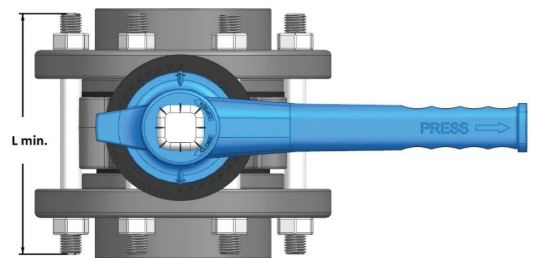
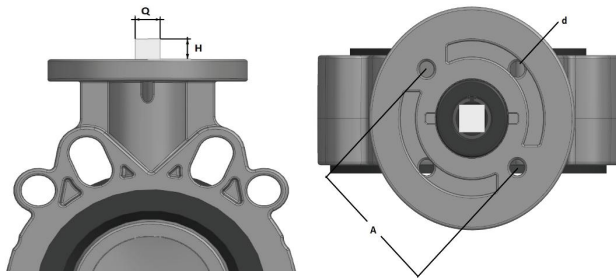

### Flanges Compatibility

NEISCO Butterfly valve compatible with flanges according to; ISO 1452-3 (position A) and ISO 7005 (position B).

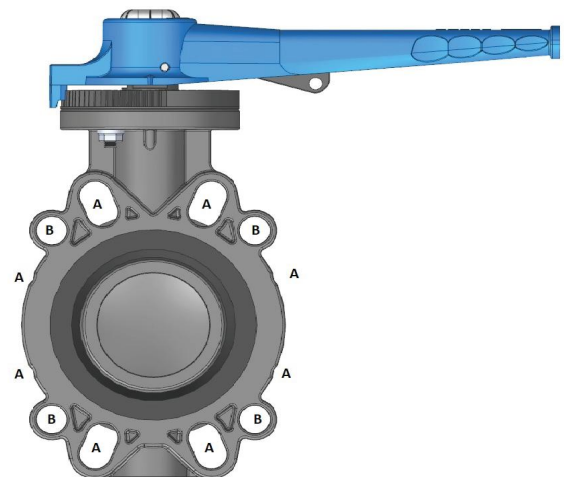

### Dimensions

d	DN	PN	A	B1	B2	C	C1	F	H	Z	g
90-3"	80	16	160	178	91	240	50	18.5	146	50	1870
110-4"	100	16	177.5	207	103.5	257	54.5	19	165	55	2580

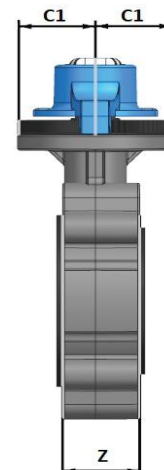
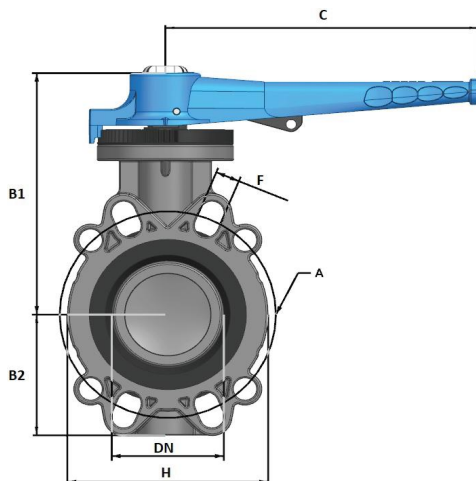

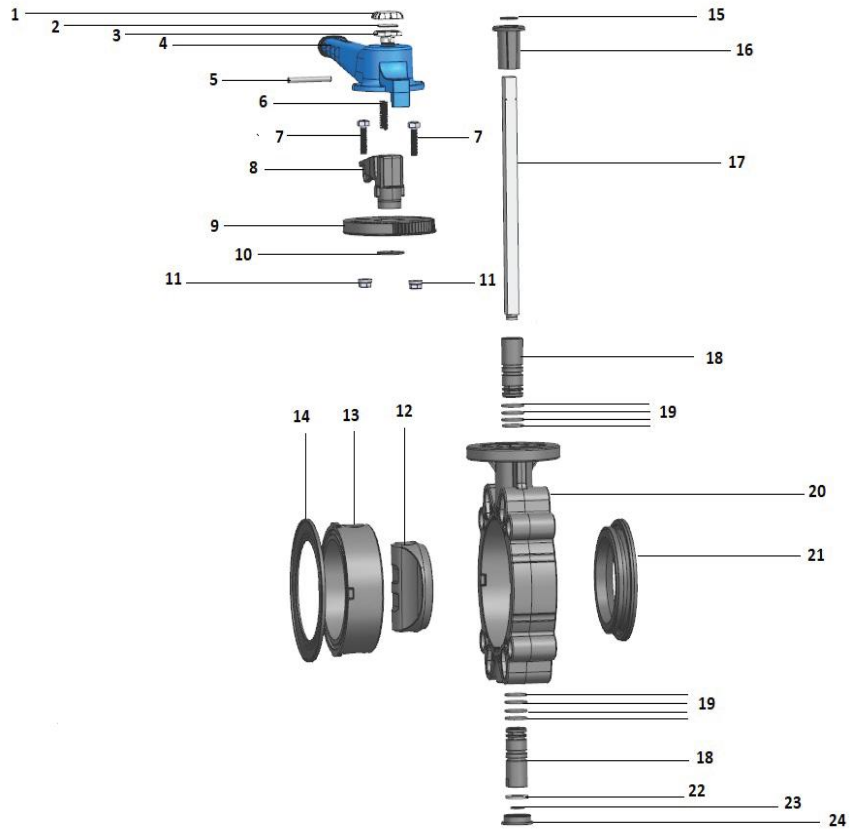

Sn	Item	Material	Qty
1	Logo part A	Q RESIN	1
2	Tag holder	CARTON	1
3	Logo part B	Q RESIN	1
4	Handle	HI - PVC	1
5	Handle pin	STAINLESS STEEL	1
6	Handle spring	COATED STEEL	1
7	Screw	ZINC PLATED STEEL	2
8	Handle support	PA6 30GF	1
9	Position indicator	PA6 30GF	1
10	Seeger ring A	STEEL	1
11	Nut	ZINC PLATED STEEL	2
12	Disk (Gate)	PVC - UH	1
13	Disk Bush	PVC - UH	1
14	Stub seal	EPDM	1
15	Seeger ring B	STEEL	1
16	Stem bush	PA6 30GF	1
17	Stem	ZINC PLATED STEEL	1
18	O-ring bush	PVC - UH	2
19	O-ring	EPDM	8
20	Body	PVC - UH	1
21	Disk seal	EPDM	1
22	Washer	STEEL	1
23	Seeger ring C	STEEL	1
24	Bottom cap	POLYPROPYLENE	1

# PP COMPRESSION FITTINGS

*KP*

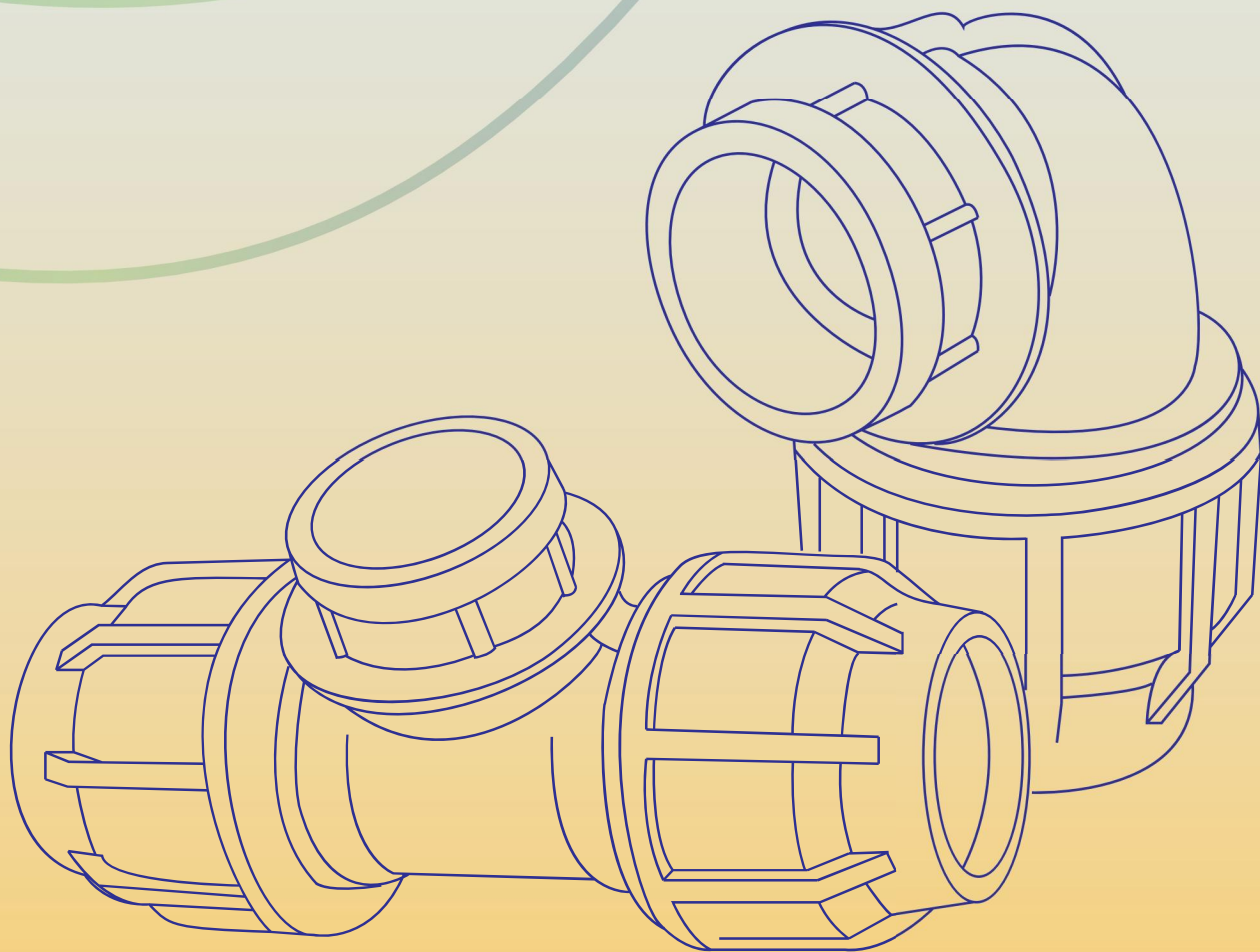

## Introduction

---

KP compression fitting is a ready installed fitting with non-disassembling procedures or breakups. Moreover, its design allows bigger size pipes to be easily inserted as there are no hindrance between the pipe and the fitting. KP compression fittings for pressure piping applications are characterized by the most innovative sealing systems. Thanks to its design, it's now possible to balance the sealing action towards the pipe through the tightening of the nut. This results to the maximum safety condition regardless of the pipe quality. No special tools are required to install the fitting with the pipeline.

## Nominal working pressure and product approvals

---

KP compression fittings are designed to be used at PN16 pressure rate from diameter 20MM up to 63MM. Bigger sizes starting from 75MM up to 100MM to be used at PN10 pressure rate. Security factors are subsequently reduced with female thread fittings. All fittings are produced and tested in accordance with the international standards.

## Materials

---

Top quality P.P block copolymer are used in producing both body and nut, thus insuring our fittings to be highly resistant and reliable in time. Our lip gaskets (special O-ring type) are made of EPDM 70 shore material, which makes our fittings compatible for potable water transfer and environmental friendly. Our lip gaskets enjoy special characters so that no pre-lubrication procedure is required. This special property gives superior hydraulic performance in case of oval, scratched or under sized pipes. Additionally, the special design of our lip gasket grants the best performance of the fittings regardless of the pressure fluctuation rates. Clinching rings are made of poly acetal (POM), which gives excellent sealing properties. The threaded female off takes starting from diameter 1.25" is reinforced with AISI 430 steel ring.

## Assembly Instructions

---

- Cut the pipe at 90 degree.
- Insert at first the locking nut then the clinching ring, avoiding pushing it too much forward into the pipe, the collar and the lip gasket.
- Feed and push the body along the pipe axis.
- The nut can be easily locked by hand for fittings starting from 20MM up to 63MM, whereas bigger diameters are advised to be locked using a wrench.

## المقدمة

لوازم وملحقات وقطع تركيب الأنابيب بالضغط "KP" عبارة عن لوازم جاهزة مسبقة التركيب لا تستلزم إجراءات الفك والتفكيك، علاوة على أن تصميمها يسمح بإدخال الأنابيب أو المواسير الأكبر حجماً بسهولة لعدم وجود أي عائق بين الماسورة أو الأنبوب وقطع وملحقات تركيبها. كما تتميز لوازم وملحقات وقطع تركيب الأنابيب بالضغط "KP" بأحدث النظم المبتكرة لعمل توازن ولمنع التسريب. وبفضل تصميمها من الممكن عمل توازن بين أثر منع التسريب من ناحية الأنابيب من خلال زيادة ربط الصامولة والشد عليها. الأمر الذي يؤدي إلى تحقيق الحد الأقصى من الأمان بغض النظر عن جودة الأنابيب. كما لا يلزم استخدام أدوات خاصة لتركيب اللوازم وقطع التركيب بخط الأنابيب.

## الضغط التشغيلي واعتماد المنتج

إن لوازم وملحقات وقطع تركيب الأنابيب بالضغط "KP" مصممة للإستخدام بمعدل ضغط تشغيلي قدرة "PN10" وبالتالي يقل عنصر الأمان بالنسبة للوازم وملحقات وقطع تركيب الأنابيب ذات السن الداخلي. ويتم إنتاج جميع لوازم وملحقات وقطع التركيب واختبارها وفقاً للمعايير الدولية.

## المواد

يستخدم البولي بروبيلين PP من أعلى جودة في إنتاج كل من جسم القطعة والصامولة، مما يضمن جودة لوازم وملحقات وقطع تركيب الأنابيب لدينا وتحملها والثوق بها طول الوقت. لدينا جوانات بشفاه خاصة من النوع ذو الحلقة على شكل حرف O مصنوعة من مادة EPDM ذات الصلادة المتميزة 70، مما يجعل تلك اللوازم والملحقات وقطع التركيب مناسبة لنقل المياه الصالحة للشرب وصديقة للبيئة، كما أن ما لدينا من جوانات بشفاه يتمتع بميزة خاصة حيث لا يلزم التشحيم قبل التركيب. هذه الميزة الخاصة تؤدي إلى أداء هيدروليكي متميز في حالة الأنابيب البيضاوية، أو التي بها خدوش أو حتي الأنابيب ذات المقاسات الأقل.

بالإضافة إلى ذلك، فإن التصميم الخاص الذي تتميز به تلك الجوانات يمنح المستخدم أفضل أداء للوازم والملحقات وقطع التركيب بغض النظر عن معدلات تذبذب الضغط، أما حلقات التشييت والبرشمة فإنها مصنوعة من البولي اسيتال التي تعطي خصائص متميزة لمنع التسريب، كما أن مخارج الأنابيب ذات السن الداخلي بدءاً من قطر 1/4 بوصة فإنها مقواة بحلقة من الفولاذ الذي لا يصدأ من الفئة 430 حسب تصنيف معهد الحديد والصلب الأمريكي.

## ارشادات التجميع والتركيب

- تقطع الأنابيب بزاوية قائمة ٩٠ درجة
- في البداية يتم إدخال صامولة الربط مع الأخذ في الإعتبار مسافة كافية للتركيب (التشييت والبرشمة)، مع تجنب دفعها للأمام داخل الأنابيب، والطوق (الجلبة) والجوانات ذات الشفاة.
- تغذية ودفع البدن على طول محور الأنابيب.
- يمكن ربط الصامولة باليد بسهولة بالنسبة للوازم وملحقات وقطع التركيب التي يصل قطرها إلى 20 ملم حتي 63 ملم، أما بداية من قطر 57 ملم حتي 110 ملم، في حين ينصح باستخدام مفتاح ربط لربط الملحقات ذات المقاسات الأكبر.

## CA370 BOUCHON

نهاية خط

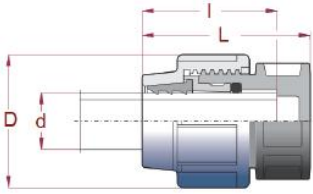

Code	d	D	d	L	l	g
CA370K0200	20	44	20	71	53	41.6
CA370K0250	25	52	25	78	59	51.2
CA370K0320	32	63	32	86	67	81.4
CA370K0400	40	76	40	105	82	174.7
CA370K0500	50	91	50	114	90	270.2
CA370K0630	63	107	63	134	105	408.4
CA370K0750	75	125	75	153	119	508.4
CA370K0900	90	150	90	165	151	779.0
CA370K1100	110	178	110	233	131	1990.0

## SO310 COUPLING

وصلة

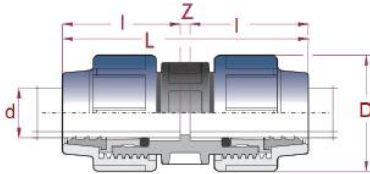

Code	d X d	D	d	L	l	Z	g
SO310K0200	20 x 20	44	20	109	53	3	62
SO310K0250	25 x 25	52	25	121	59	3	93
SO310K0320	32 x 32	63	32	137	67	3	131
SO310K0400	40 x 40	76	40	167	82	3	270
SO310K0500	50 x 50	91	50	184	90	4	430
SO310K0630	63 x 63	107	63	214	105	4	670
SO310K0750	75 x 75	125	75	243	119	5	894
SO310K0900	90 x 90	150	90	307	151	5	1330
SO310K1100	110 x 110	178	110	396	190	39	3227

## RS310 REDUCING COUPLING

وصلة مخفضة

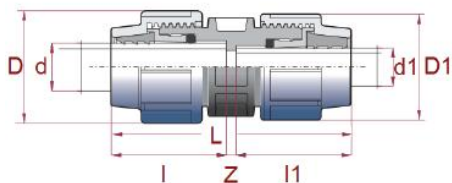

Code	d X d	D	d	D1	d1	L	l	l1	Z	g
RS310K032C	32 x 25	63	32	52	25	129	67	59	4	120
RS310K040D	40 x 32	76	40	63	32	153	82	67	9	240
RS310K050D	50 x 32	91	50	63	32	168	89	67	9	350
RS310K050E	50 x 40	91	50	76	40	175	89	82	6	380
RS310K063E	63 x 40	107	63	76	40	194	105	82	5	499
RS310K063F	63 x 50	107	63	91	50	199	105	90	2	600
RS310K075G	75 x 63	125	75	107	63	219	119	105	3	800





## AD312

### RACCORD MALE

بداية خط سن خارجي

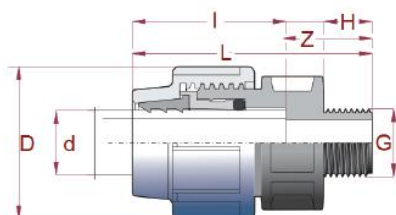

Code	d x G	D	d	L	l	H	Z	g
AD312K020B	20 x 1/2"	44	20	88	53	18	35	38
AD312K020C	20 x 3/4"	44	20	88	53	18	35	40
AD312K025B	25 x 1/2"	52	25	94	59	18	35	50
AD312K025C	25 x 3/4"	52	25	95	59	18	36	52
AD312K025D	25 x 1"	52	25	97	59	20	38	52
AD312K032C	32 x 3/4"	63	32	102	67	18	35	78
AD312K032D	32 x 1"	63	32	106	67	20	39	80
AD312K032E	32 x 1 1/4"	63	32	106	67	22	41	90
AD312K040D	40 x 1"	76	40	127	82	22	45	140
AD312K040E	40 x 1 1/4"	76	40	129	82	24	47	150
AD312K040F	40 x 1 1/2"	76	40	129	82	24	47	160
AD312K050F	50 x 1 1/2"	91	50	140	90	24	50	236
AD312K050G	50 x 2"	91	50	141	90	26	51	250
AD312K063F	63 x 1 1/2"	107	63	154	105	24	49	380
AD312K063G	63 x 2"	107	63	160	105	26	55	390
AD312K075G	75 x 2"	125	75	179	119	26	60	730
AD312K075H	75 x 2 1/2"	125	75	178	119	26	59	750
AD312K090I	90 x 3"	150	90	213	151	28	62	774
AD312K110L	110 x 4"	176	110	244	171	35	73	1400

## SO312

### ADAPTOR FEMALE THREADED

بداية خط سن داخلي

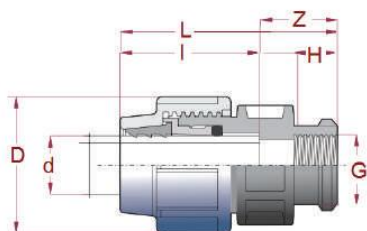

Code	d x G	D	d	L	l	H	Z	g
SO312K020B	20 x 1/2"	44	20	89	53	18	18	54
SO312K020C	20 x 3/4"	44	20	90	53	18	19	60
SO312K025C	25 x 3/4"	52	25	99	58	18	18	67
SO312K025D	25 x 1"	52	25	104	58	20	20	74
SO312K032C	32 x 3/4"	63	32	106	67	18	19	90
SO312K032D	32 x 1"	63	32	123	67	20	19	95
SO312K040E	40 x 1 1/4"	76	40	128	82	22	24	200
SO312K040F	40 x 1 1/2"	76	40	128	82	27	19	220
SO312K050F	50 x 1 1/2"	91	50	139	90	27	22	253
SO312K050G	50 x 2"	91	50	145	90	29	22	270
SO312K063G	63 x 2"	107	63	160	105	29	26	440
SO312K075G	75 x 2"	125	75	179	119	29	26	780
SO312K075H	75 x 2 1/2"	125	75	179	119	30	30	820
SO312K090I	90 x 3"	150	90	217	151	33	33	1000

## TR340

### TEE 90° REDUCED

مشترك 90° مخفض

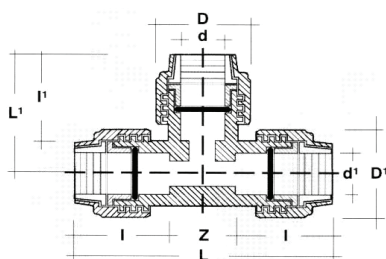

Code	d x G	D	D1	d	d1	L	L1	i	l1	z	gr
TR340K050E	50 X 40	90.7	76.8	51.4	41.8	237.2	109	88.8	76.9	58.8	667
TR340K063F	63 X 50	108.6	90.9	64.3	50.8	280.4	127.5	103.1	88.2	74.1	1064
TR340K090F	90 X 50	146.1	90.9	94.3	51.9	333.3	141.9	129.4	89.5	111.2	1175

## TE340

TEE 90°

مشارك 90°

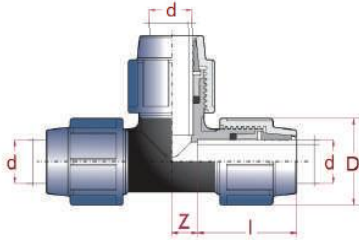

Code	d x d x d	D	d	L	I	L1	Z	g
TE340K0200	20 x 20 x 20	44	20	130	53	65	24	100
TE340K0250	25 x 25 x 25	52	25	147	59	73	29	150
TE340K0320	32 x 32 x 32	63	32	168	67	84	34	230
TE340K0400	40 x 40 x 40	76	40	207	82	103	43	430
TE340K0500	50 x 50 x 50	91	50	234	90	117	54	680
TE340K0630	63 x 63 x 63	107	63	277	105	138	67	1100
TE340K0750	75 x 75 x 75	125	75	319	119	159	81	1900
TE340K0900	90 x 90 x 90	150	90	402	151	201	100	2200
TE340K1100	110 x 110 x 110	178	110	603	203	210	196	4200

## TE341

TEE 90° WITH  
THREADED  
MALE OFFTAKE

مشارك 90° ذو سن خارجي

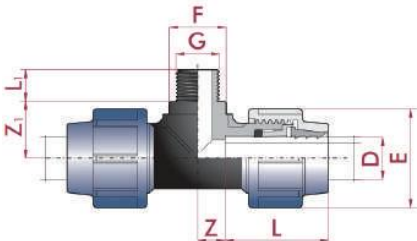

Code	d x G x d	D	d	L	I	L1	H	Z	g
TE341K020B	20 x 1/2" x 20	44	20	130	53	45	18	24	73
TE341K020C	20 x 3/4" x 20	44	20	130	53	45	18	24	75
TE341K025C	25 x 3/4" x 25	52	25	147	59	49	18	29	90
TE341K025D	25 x 1" x 25	52	25	147	59	51	22	29	94
TE341K032C	32 x 3/4" x 32	63	32	168	67	53	18	34	140
TE341K032D	32 x 1" x 32	63	32	168	67	56	22	34	142
TE341K040E	40 x 1 1/4" x 40	76	40	207	82	64	24	43	261
TE341K050F	50 x 1 1/2" x 50	91	50	234	90	73	26	54	423
TE341K063G	63 x 2" x 63	107	63	277	105	86	28	67	678

## TE342

TEE 90° WITH  
THREADED  
FEMALE OFFTAKE

مشارك 90° ذو سن داخلي

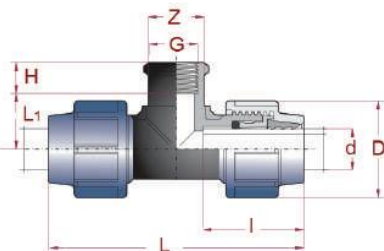

Code	d x G x d	D	d	L	I	L1	H	Z	g
TE342K020B	20 x 1/2" x 20	44	20	130	53	42	18	24	78
TE342K020C	20 x 3/4" x 20	44	20	130	53	42	18	24	82
TE342K025B	25 x 1/2" x 25	52	25	147	59	42	18	29	132
TE342K025C	25 x 3/4" x 25	52	25	147	59	47	18	29	134
TE342K025D	25 x 1" x 25	52	25	147	59	50	20	29	138
TE342K032C	32 x 3/4" x 32	63	32	168	67	51	18	34	201
TE342K032D	32 x 1" x 32	63	32	168	67	53	20	34	205
TE342K040D	40 x 1" x 40	76	40	207	82	53	20	43	330
TE342K040E	40 x 1 1/4" x 40	76	40	207	82	61	22	43	347
TE342K050F	50 x 1 1/2" x 50	91	50	234	90	71	27	54	619
TE342K063G	63 x 2" x 63	107	63	277	105	85	29	67	939
TE342K075H	75 x 2 1/2" x 75	125	75	319	119	95	30	81	1239
TE342K090I	90 x 3" x 90	150	90	402	151	111	33	100	1912





## EL350

ELBOW 90°

كوع 90°

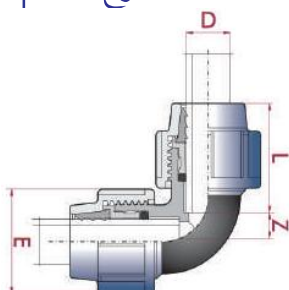

Code	d x d	D	d	L	l	Z	g
EL350K0200	20 x 20	44	20	65	53	12	76
EL350K0250	25 x 25	52	25	73	59	14	112
EL350K0320	32 x 32	63	32	84	67	17	178
EL350K0400	40 x 40	76	40	103	82	21	340
EL350K0500	50 x 50	91	50	117	90	27	540
EL350K0630	63 x 63	107	63	138	105	33	828
EL350K0750	75 x 75	125	75	159	119	40	1038
EL350K0900	90 x 90	150	90	201	151	50	1600
EL350K1100	110 x 110	178	110	279	193	96	3925

## EL351

ELBOW 90° WITH  
THREADED  
MALE OFFTAKE

كوع 90° ذو سن خارجي

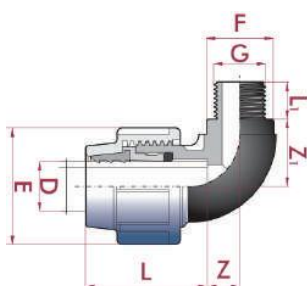

Code	d x G	D	d	L	l	L1	H	Z	g
EL351K020B	20 x 1/2"	44	20	65	53	45	18	12	51
EL351K020C	20 x 3/4"	44	20	65	53	45	18	12	53
EL351K025B	25 x 1/2"	52	25	73	59	49	18	14	75
EL351K025C	25 x 3/4"	52	25	73	59	49	18	14	78
EL351K025D	25 x 1"	52	25	73	59	51	22	14	79
EL351K032D	32 x 1"	63	32	84	67	56	22	17	112
EL351K040E	40 x 1 1/4"	76	40	103	82	64	24	21	246
EL351K050F	50 x 1 1/2"	91	50	117	90	75	28	27	401
EL351K050G	50 x 2"	91	50	117	90	75	28	27	395
EL351K063G	63 x 2"	107	63	138	105	86	28	33	607

## EL352

ELBOW 90° WITH  
THREADED  
FEMALE OFFTAKE

كوع 90° ذو سن داخلي

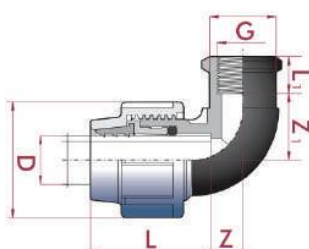

Code	d x G	D	d	L	l	L1	H	Z	g
EL352K020B	20 x 1/2"	44	20	65	53	42	18	12	56
EL352K020C	20 x 3/4"	44	20	65	53	42	18	12	61
EL352K025C	25 x 3/4"	52	25	73	59	47	18	14	81
EL352K025D	25 x 1"	52	25	73	59	50	20	14	89
EL352K032C	32 x 3/4"	63	32	84	67	51	18	17	117
EL352K032D	32 x 1"	63	32	84	67	53	20	17	119
EL352K040E	40 x 1 1/4"	76	40	103	82	61	22	21	242
EL352K050F	50 x 1 1/2"	91	50	117	90	71	27	27	399
EL352K050G	50 x 2"	91	50	117	90	71	27	33	443
EL352K063G	63 x 2"	107	63	138	105	85	29	33	607
EL352K075H	75 x 2 1/2"	125	75	159	119	97	30	40	789
EL352K090I	90 x 3"	150	90	201	151	111	33	80	1211

# PP CLAMP SADDLES

*KP*

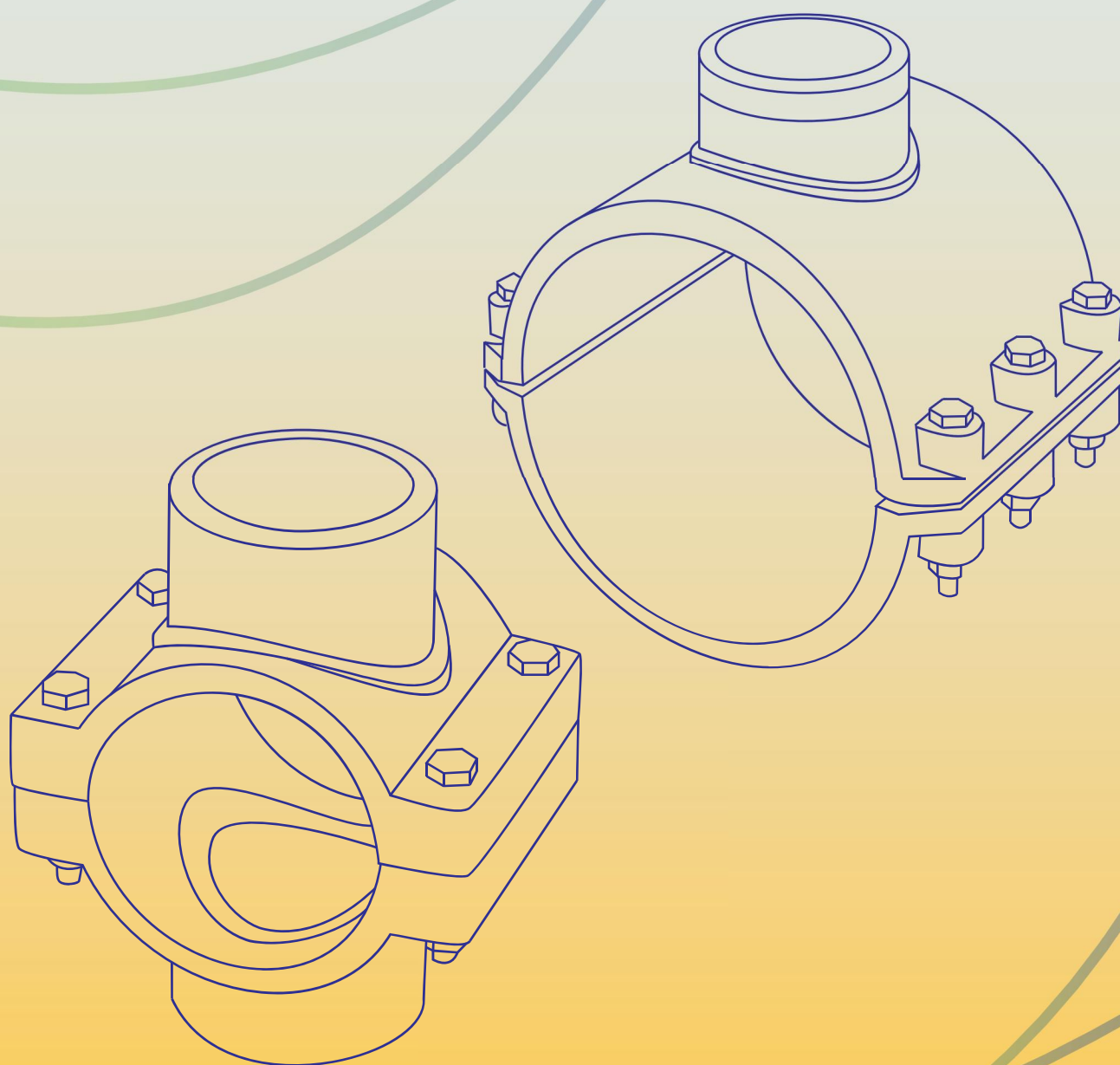

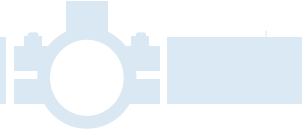

## PP Clamp Saddles - Intro

KP PP Clamp saddles are the best solution for branching pipelines for water and irrigation applications. KP PP Clamp saddles are commonly used in the fields of irrigation, high pressure conveyance of water and chemical solutions.

## Range

KP PP Clamp saddles can be supplied in the following types:

- Single/Double branch. Coupling with pipes from D20 mm to D160 mm. Threaded branches start from 1/2" to 4", provided with 2, 4 or 6 reinforced with metal ring on it's threaded branch starting from 1' 1/4".

## Components

- Bolts and nuts: Galvanized steel or stainless steel.
- Bracket bottom: Polypropylene (PP-B) with high degree of stability and protection against UV.
- Load bracket: Polypropylene (PP-B) with high degree of stability and protection against UV.
- O-ring gasket: EPDM rubber shore 70.

## ركابات البولي بروبلين - مقدمة

تعتبر الركابات أفضل حل لتفريغ خطوط الأنابيب للإستخدامات المائية والرى ، وعادة ما تستخدم الركابات "KP" والمصنوعة من مادة البولي بروبلين "PP" فى مجالات الرى ، ونقل المياه والمحاليل الكيميائية بالضغط العالى.

## نطاق الإنتاج

تتوفر ركابات ال KP بطرازين (فرع واحد وفرعين) بأقطار أجسام تتصل بالأنابيب تبدأ من قطر 20 إلى 160 ملم، أما الرأس المسننة (أفرع التوزيع) فتبدأ من 1/2 بوصة إلى 4 بوصة ، ويتم توفير أجسام الركابات ب 2، 4 أو 6 مسامير مقواة كما يوجد ركابات بحلقة معدنية علي الرأس المسنن بدءا من 1 و 1/4 بوصة إلى 4 بوصة.

## المكونات

- المسامير والصواميل: فولاذ مجلفن أو فولاذ لا يصدأ.
- أجسام الركابات: بولى بروبلين مع درجة عالية من الثبات والحماية ضد الأشعة فوق البنفسجية.
- الجوانات بشفاه (من النوع ذو الحلقة علي شكل حرف O) مصنوعة من مطاط EPDM.

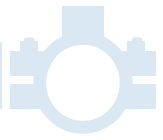

## WITHOUT METAL RINGS

### SA3512

SADDLE GALVANIZED  
2 BOLTS

ركاب أحادي المخرج



Item code	d x g	Weight
SA3512K032B	32 x 1/2	68.1
SA3512K032C	32 x 3/4	70.8
SA3512K050B	50 x 1/2	131.1
SA3512K050C	50 x 3/4	134.1
SA3512K050D	50 x 1	136.1
SA3512K063B	63 x 1/2	171.8
SA3512K063C	63 x 3/4	175.8
SA3512K063D	63 x 1	183.88
SA3512K063E	63 x 1 1/4	195.6

### SA3612

DOUBLE SADDLE  
GALVANIZED 2 BOLTS

ركاب ثنائي المخرج



Item code	d x g	Weight
SA3612K032B	32 x 1/2	76.4
SA3612K032C	32 x 3/4	81.4
SA3612K050B	50 x 1/2	138.8
SA3612K050C	50 x 3/4	143.6
SA3612K050D	50 x 1	152.3
SA3612K063B	63 x 1/2	180.5
SA3612K063C	63 x 3/4	188.3
SA3612K063D	63 x 1	196.7
SA3612K063E	63 x 1 1/4	209.3

### SA3514

SADDLE GALVANIZED  
4 BOLTS

ركاب أحادي المخرج



Item code	d x g	Weight
SA3514K075B	75 x 1/2	332.4
SA3514K075C	75 x 3/4	334.8
SA3514K075D	75 x 1	339.3
SA3514K075F	75 x 1 1/2	348.8
SA3514K075G	75 x 2	385.2
SA3514K090B	90 x 1/2	438.5
SA3514K090C	90 x 3/4	436.3
SA3514K090D	90 x 1	443.6
SA3514K090E	90 x 1 1/4	472.1
SA3514K090F	90 x 1 1/2	452.8
SA3514K090G	90 x 2	484.6
SA3514K110C	110 x 3/4	535.5
SA3514K110D	110 x 1	542.1
SA3514K110E	110 x 1 1/4	556.4
SA3514K110F	110 x 1 1/2	553.5
SA3514K110G	110 x 2	581.9
SA3514K110I	110 x 3	635.7

### SA3614

DOUBLE SADDLE  
GALVANIZED 4 BOLTS

ركاب ثنائي المخرج



Item code	d x g	Weight
SA3614K075B	75 x 1/2	353.7
SA3614K075C	75 x 3/4	358.3
SA3614K075D	75 x 1	367.8
SA3614K075F	75 x 1 1/2	475.9
SA3614K075G	75 x 2	525.4
SA3614K090B	90 x 1/2	463.4
SA3614K090C	90 x 3/4	462.7
SA3614K090D	90 x 1	475.7
SA3614K090E	90 x 1 1/4	539.8
SA3614K090F	90 x 1 1/2	503.3
SA3614K090G	90 x 2	569.1
SA3614K110C	110 x 3/4	539.1
SA3614K110D	110 x 1	548.3
SA3614K110E	110 x 1 1/4	589.5
SA3614K110F	110 x 1 1/2	587.6
SA3614K110G	110 x 2	648.6
SA3614K110I	110 x 3	775.9

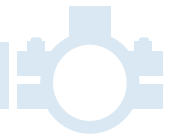

## WITHOUT METAL RINGS

### SA3516

SADDLE GALVANIZED  
6 BOLTS

ركاب أحادي المخرج



Item code	d x g	Weight
SA3516K160D	160 x 1	1092
SA3516K160F	160 x 1 1/2	1095.4
SA3516K160G	160 x 2	1116.1
SA3516K160I	160 x 3	1161.2
SA3516K160L	160 x 4	1183.1

### SA3616

DOUBLE SADDLE  
GALVANIZED 6 BOLTS

ركاب ثنائي المخرج



Item code	d x g	Weight
SA3616K160D	160 x 1	1111.2
SA3616K160F	160 x 1 1/2	1121.7
SA3616K160G	160 x 2	1174.7
SA3616K160I	160 x 3	1280.1
SA3616K160L	160 x 4	1394.2

## WITH METAL RINGS

### SA3712

SADDLE GALVANIZED  
2 BOLTS

ركاب أحادي المخرج



Item code	d x g	Weight
SA3712K032B	32 x 1/2	71.82
SA3712K032C	32 x 3/4	76.38
SA3712K050B	50 x 1/2	134.82
SA3712K050C	50 x 3/4	139.68
SA3712K050D	50 x 1	143.54
SA3712K063B	63 x 1/2	175.52
SA3712K063C	63 x 3/4	181.38
SA3712K063D	63 x 1	191.24
SA3712K063E	63 x 1 1/4	201.12

### SA3812

DOUBLE SADDLE  
GALVANIZED 2 BOLTS

ركاب ثنائي المخرج



Item code	d x g	Weight
SA3812K032B	32 x 1/2	83.84
SA3812K032C	32 x 3/4	92.56
SA3812K050B	50 x 1/2	146.24
SA3812K050C	50 x 3/4	154.76
SA3812K050D	50 x 1	167.18
SA3812K063B	63 x 1/2	187.94
SA3812K063C	63 x 3/4	199.46
SA3812K063D	63 x 1	211.58
SA3812K063E	63 x 1 1/4	224.44

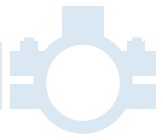

## WITH METAL RINGS

### SA3714

SADDLE GALVANIZED  
4 BOLTS

ركاب أحادي المخرج



Item code	d x g	Weight
SA3714K075B	75 x 1/2	336.12
SA3714K075C	75 x 3/4	340.38
SA3714K075D	75 x 1	346.74
SA3714K075F	75 x 1"1/2	360.4
SA3714K075G	75 x 2	401.5
SA3714K090B	90 x 1/2	442.22
SA3714K090C	90 x 3/4	446.72
SA3714K090D	90 x 1	451.04
SA3714K090E	90 x 1"1/4	481.4
SA3714K090F	90 x 1"1/2	492.4
SA3714K090G	90 x 2	500.9
SA3714K110C	110 x 3/4	541.08
SA3714K110D	110 x 1	549.54
SA3714K110E	110 x 1"1/4	565.7
SA3714K110F	110 x 1"1/2	581.3
SA3714K110G	110 x 2	598.2
SA3714K110I	110 x 3	668.8

### SA3814

DOUBLE SADDLE  
GALVANIZED 4 BOLTS

ركاب ثنائي المخرج



Item code	d x g	Weight
SA3814K075B	75 x 1/2	361.14
SA3814K075C	75 x 3/4	369.46
SA3814K075D	75 x 1	382.68
SA3814K075F	75 x 1"1/2	499.1
SA3814K075G	75 x 2	508.4
SA3814K090B	90 x 1/2	470.84
SA3814K090C	90 x 3/4	473.86
SA3814K090D	90 x 1	490.58
SA3814K090E	90 x 1"1/4	558.4
SA3814K090F	90 x 1"1/2	576.5
SA3814K090G	90 x 2	601.8
SA3814K110C	110 x 3/4	553.98
SA3814K110D	110 x 1	563.18
SA3814K110E	110 x 1"1/4	608.1
SA3814K110F	110 x 1"1/2	610.8
SA3814K110G	110 x 2	681.2
SA3814K110I	110 x 3	842.1

### SA3716

SADDLE GALVANIZED  
6 BOLTS

ركاب أحادي المخرج



Item code	d x g	Weight
SA3716K160D	160 x 1	1099.44
SA3716K160F	160 x 1"1/2	1107
SA3716K160G	160 x 2	1132.4
SA3716K160I	160 x 3	1262.77
SA3716K160L	160 x 4	1408.15

### SA3816

DOUBLE SADDLE  
GALVANIZED 6 BOLTS

ركاب ثنائي المخرج



Item code	d x g	Weight
SA3816K160D	160 x 1	1126.08
SA3816K160F	160 x 1"1/2	1144.9
SA3816K160G	160 x 2	1207.3
SA3816K160I	160 x 3	1346.3
SA3816K160L	160 x 4	1501.2



# IN LINE & ONLINE DRIPPERS

*KP*

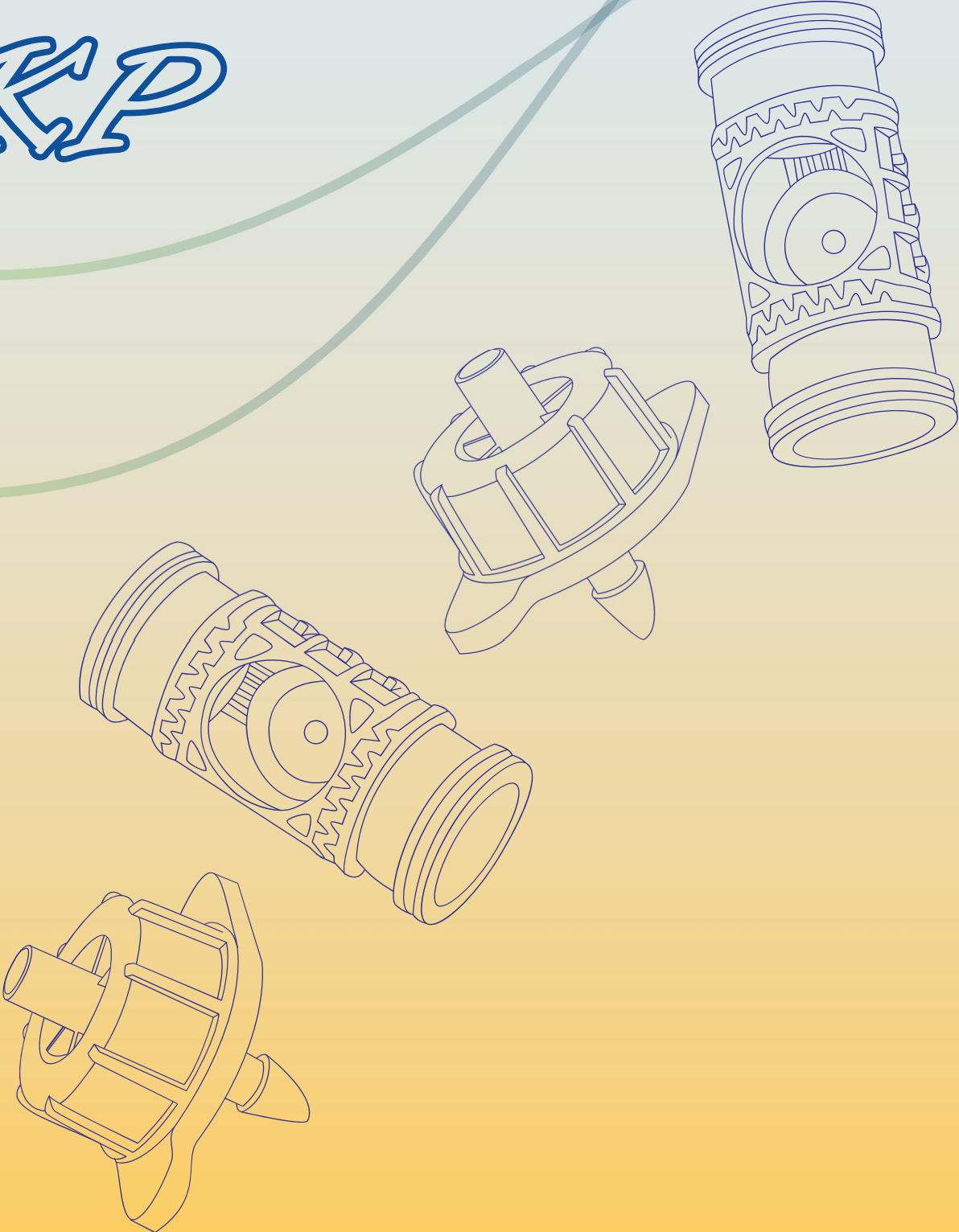

## Drip Line GR16® (Non-PC)

KP Dripline GR16 is an integral dripline manufactured in various wall thickness, flow rates, and dripper spacings. KP Driplines utilize a cylindrical dripper, designed with a large cross-sectional labyrinth. This configuration provides a turbulent water flow which minimizes the formation of residues that may cause clogging. KP driplines are manufactured with two outlets and one inlet filters which ensure high resistance to clogging and reliable long life performance. KP Dripline is a durable thick walled drip line, ideal for field crops, orchards, greenhouses and landscapes.

### Specifications

- Dripper flow rates: 2L, 4L/Hr.
- Dripper spacing(s): Starts from 20 cm up to 150 cm.
- Pressure compensation range: 0.9 to 1.1 Bar.
- Maximum recommended system pressure: 5 Bar.
- Tubing diameter: 16 mm OD; 13.8 mm (form 0.8 : 1.1 m wall)
- Coil length: 400 meter.
- Recommended minimum filtration: 120 mesh (4L); 150 mesh (2L).
- Material: Both dripline and drippers are made of polyethylene material.



### Limited warranty for Drip Line

KP warrants Drip Line GR16 to be free from environmental stress cracking for a period of 7 years from the manufacturing date.

### المقدمة

خطوط أنابيب الري بالتنقيط موديل GR16 ماركة KP عبارة عن خطوط أنابيب متكاملة للري بالتنقيط يتم تصنيعها بجدران ذات سماكة متنوعة ومعدلات تدفق مختلفة، كما تختلف المساحات التي يغطيها المنقط. خطوط أنابيب الري بالتنقيط KP يستخدم فيها منقط اسطوانى الشكل مصمم بتصميم مقطعى كبير حيث يؤدي هذا التصميم إلى الدفع الدوامى للمياه مما يقلل من ترسيب المخلفات طبقاً لنظرية "الطرد المركزى" والتي قد تسبب فى انسداد مسارات التنقيط.

يتم تصنيع خطوط أنابيب الري بالتنقيط KP بمدخل واحد مزود بفلتر مع منفذين لتصريف للمياه مما يضمن مقاومة عالية للانسداد وأداء موثوق وعمر أطول. خطوط أنابيب الري بالتنقيط KP متينة ومعمرة ذو جدران سميكة، مثالية للمحاصيل الحقلية، والبساتين، والصوب، والمساحات الخضراء.

### المواصفات:

- معدلات تدفق المنقط: من 2 إلى 4 لتر/ساعة
- مساحة تغطية المنقط: تبدأ من 20 سم وتصل إلى 150 سم
- مدى تعويض فرق الضغط: من 0.9 إلى 1.1 بار
- الحد الأقصى الموصى به لضغط النظام: 5 بار
- قطر الأنبوب: القطر الخارجى 16 ملم - القطر الداخلى 13.8 ملم (سمك الجدار من 0.8 إلى 1.1 ملم)
- طول اللفة: 400 متر.
- المواد: كلا من خطوط أنابيب الري بالتنقيط والمنقط مصنوعان من مادة البولى إيثيلين منخفض الكثافة.





## GR Drip Line (NDLN)

All GR drip line types are produced by default "1.1 ml" thickness and any other spaces or thickness will be as per request.

Item code	D.mm	Th.mm	Flow	Sp.Cm.
NDLN161102020	16	1.1	2 L/H	20
NDLN161102030	16	1.1	2 L/H	30
NDLN161102033	16	1.1	2 L/H	33
NDLN161102040	16	1.1	2 L/H	40
NDLN161102050	16	1.1	2 L/H	50
NDLN161102060	16	1.1	2 L/H	60
NDLN161102070	16	1.1	2 L/H	70
NDLN161102100	16	1.1	2 L/H	100
NDLN161104020	16	1.1	4 L/H	20
NDLN161104025	16	1.1	4 L/H	25
NDLN161104030	16	1.1	4 L/H	30
NDLN161104033	16	1.1	4 L/H	33
NDLN161104040	16	1.1	4 L/H	40
NDLN161104050	16	1.1	4 L/H	50
NDLN161104060	16	1.1	4 L/H	60
NDLN161104075	16	1.1	4 L/H	75
NDLN161104100	16	1.1	4 L/H	100

### FLOW RATE DATA

Code	Color/Flow (L/h)	Spacing between drippers Maximum recommended drip line length (m) on flat terrain							
		20	25	30	33	40	50	75	100
NIDNL02	Red 2.2	40	45	50	58	70	79	102	128
NIDNL04	Black 4.2	28	32	38	44	50	55	84	103

### Drippers Curves

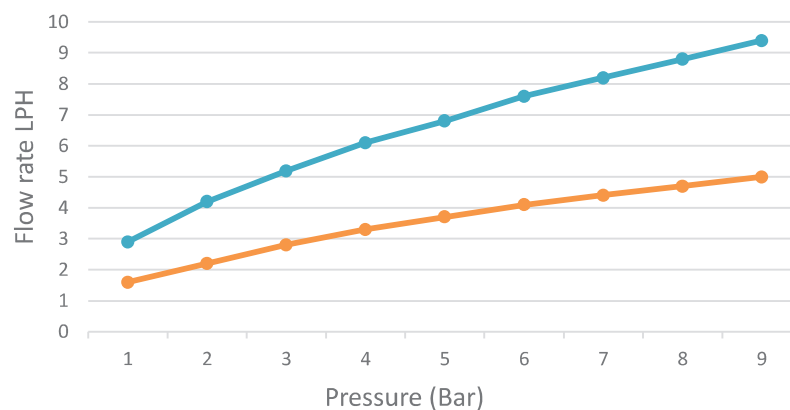

2 LPH	1.6	2.2	2.8	3.3	3.7	4.1	4.4	4.7	5
4 LPH	2.9	4.2	5.2	6.1	6.8	7.6	8.2	8.8	9.4

## Drip Line GR16® (PC)

The PC DRIPPER is compensating flow emitters with silicone rubber diaphragm that regulate water discharge at different pressures. These flow emitters come in two models 2 & 4 L/H. It is recommended to use PC dripline in highly land areas or terrains with different level of inclination.

### Specifications

- Dripper flow rates: 2.2 L/Hr , 3.8 L/Hr.
- Dripper spacing(s): Starts from 20 cm up to 150 cm.
- Maximum recommended system pressure: 4 Bar.
- Tubing diameter: 16 mm OD; 13.8 mm ID; (from 0.9:1.1 mm wall)
- Coil length: 400 meter.
- Recommended minimum filtration: 3.8/LH mesh. 2.2/LH 150 mesh.
- Material: Both dripline and drippers are made of polyethylene material.



### Limited warranty for Drip Line

KP warrants Drip Line GR16 to be free from environmental stress cracking for a period of 7 years from the manufacturing date.

## خطوط أنابيب الري بالتنقيط GR16 (النقاط المنظمة للضغط - PC)

في المنقطات المنظمة للضغط يستعاض عن ناقطات التدفق بغشاء من السيليكون المطاط ينظم تصريف المياه تحت معدلات الضغط المختلفة. وهناك طرازان من المنقط المنظم للضغط، الطراز الأول 2 لتر في الساعة والآخر 4 لتر في الساعة. - يوصي باستخدام خطوط التنقيط المنظمة للضغط في مناطق الأراضي المرتفعة أو التربة ذات المستويات المختلفة من الميل.

### المواصفات

- معدلات تدفق المنقط: من 2.2 إلى 8.3 لتر/ساعة
- مساحة تغطية المنقط: تبدأ من 20 سم وتصل إلى 150 سم
- الحد الأقصى الموصى به لضغط النظام: 4 بار
- قطر الأنبوب: القطر الخارجي 16 ملم - القطر الداخلي 13.8 ملم (سمك الجدار من 0.9 إلى 1.1 ملم)
- طول اللفة: 400 متر
- الحد الأدنى الموصى به للترشيح: 3.8 لتر/ ساعة 120 ثقب - 2.2 لتر/ ساعة 150 ثقب.
- المواد: كلا من خطوط أنابيب الري بالتنقيط والمنقط مصنوعان من مادة البولي إيثيلين.

### الضمان المحدود لخطوط أنابيب الري بالتنقيط:

تضمن KP خطوط أنابيب الري بالتنقيط موديل GR16 لمدة سبعة (7) سنوات من تاريخ التصنيع ضد التصدع والشروخ الناجمة عن الإجهاد البيئي.



## GR Drip Line (NDLP)

All GR drip line types are produced by default "1.1 ml" thickness and any other spaces or thickness will be as per request.

Item code	D.mm	Th.mm	Flow	Sp.Cm.
NDLP161102020	16	1.1	2 L/H	20
NDLP161102030	16	1.1	2 L/H	30
NDLP161102033	16	1.1	2 L/H	33
NDLP161102040	16	1.1	2 L/H	40
NDLP161102050	16	1.1	2 L/H	50
NDLP161102060	16	1.1	2 L/H	60
NDLP161102070	16	1.1	2 L/H	75
NDLP161102100	16	1.1	2 L/H	100
NDLP161104020	16	1.1	4 L/H	20
NDLP161104025	16	1.1	4 L/H	25
NDLP161104030	16	1.1	4 L/H	30
NDLP161104033	16	1.1	4 L/H	33
NDLP161104040	16	1.1	4 L/H	40
NDLP161104050	16	1.1	4 L/H	50
NDLP161104060	16	1.1	4 L/H	60
NDLP161104075	16	1.1	4 L/H	75
NDLP161104100	16	1.1	4 L/H	100

## FLOW RATE (L/H) TABLE FOR DRIPPER PC

جدول معدل التدفق (لتر/الساعة) لمنقط المنظم للضغط

Code	Flow rate (L/H)	Pressure					
		1 bar	2 bar	2.5 bar	3 bar	3.5 bar	4 bar
NIDPL02	2 L/h	1.73	2.04	2.18	2.21	2.32	2.19
NIDPL04	4 L/h	3.86	4.07	4.23	4.35	4.18	3.96

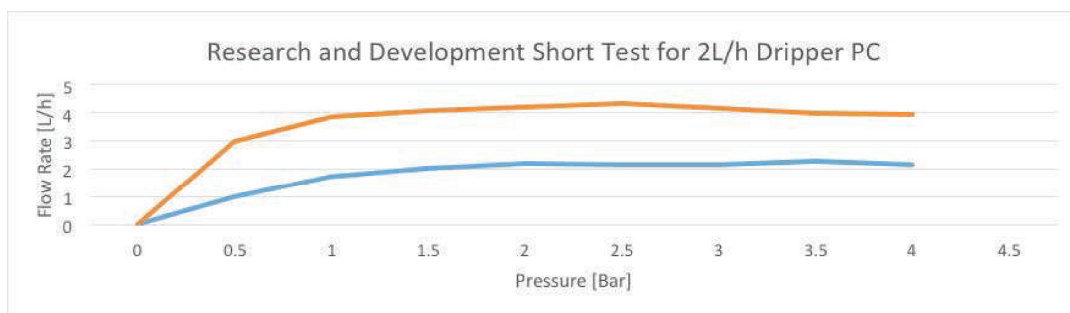

## BLIND TUBES

الخراطيم السادة

Code	Diameter	Thickness	Weight/meter
NPL16090	16	0.9	42 grams
NPL16110	16	1.1	46 grams
NPL16120	16	1.2	62 grams
NPL16140	16	1.4	67 grams

## On-line Drip Emitters

On-line drippers are small plastic devices with NPC/PC types, which convey small streams of flow from polyethylene (PE) tubing to soil. On-line emitter is an excellent choice for users who install emission device exactly where wanted. On-line drippers come in two different types;

### Turbo / Non-PC

- Turbulent flow on-line drippers
- Outstanding Non-PC drippers
- Constant water flow rates over a wide pressure range

## Features

- Provides a turbulent flow and ensures years of non-clogging performance.
- Ensures constant flow rates along long run drip lines and under challenging topographical conditions.
- Flushing mechanism easily by using special key.
- Suitable for poor quality water
- Low profile construction avoids mechanical damage in fields.
- Manufactured from superior, durable materials for long life.
- Protected against UV degradation.
- Resistance against chemicals and fertilizers used in agriculture.
- Recommended minimum filtration: 150 mesh.
- Complies with emission uniformity category A (ISO9261)

## Specifications

Available in flow rates 2,4,8,16 LPH

## ناقطات التنقيط المتصلة بالأنابيب

ناقطات التنقيط المتصلة عبارة عن أجهزة بلاستيكية صغيرة من نوعين منقطات منظمة للضغوط PC ومنقطات غير منظمة للضغوط Non-PC تنقل تيارات صغيرة من تدفق أنابيب البولي الإيثيلين إلى التربة. ناقطات التنقيط المتصلة خيار ممتاز للمستخدمين يشنون أجهزة التنقيط تحديداً في الأماكن التي يريدونها. ناقطات التنقيط المتصلة نوعين مختلفين: Turbo Non-PC and Turbo PC.

## التربو / Non - PC

منقطات غير منظمة للضغوط Non - PC متميزة بمعدلات تدفق ثابتة علي نطاق ضغط واسع.

## الخصائص والمميزات:

- توفر تدفق دوامي وتضمن سنوات من الأداء دون انسداد
- تضمن معدلات تدفق ثابتة في خطوط الري بالتنقيط الطويلة وفي الظروف الطبوغرافية الصعبة.
- سهولة التنظيف باستخدام مفتاح خاص.
- مناسبة للمياه ذات النوعية الرديئة.
- قلة بروزها أعلي الأنبوب يجنبها الأضرار والتلف الميكانيكي في الحقول.
- مصنوعة من أجود وأمتن المواد لعمر أطول.
- محمية من التصدع والتحلل الناتج عن الأشعة فوق البنفسجية
- مقاومة للمواد الكيميائية والأسمدة المستخدمة في الزراعة.
- الحد الأدنى الموصي به للترشيح: 150 ثقب / بوصة.
- مطابقة للفئة (أ) من معدات الري بالتنقيط (إيزو 9261)

المواصفات: متوفرة بمعدلات تدفق 2, 4, 8, 16 لتر في الساعة.



### Technical data:

### البيانات الفنية

Code	Color	FLOW LPH
NODNL02	Black	2 LPH
NODNL04	Blue	4 LPH
NODNL08	Brown	8 LPH
NODNL16	Green	16 LPH

- Recommended operating pressure: 0.8-2.5 bar
- Inlet size: 1/4 inch barb
- Outlet side: 1/8 inch barb
- Filter requirement: 150 mesh
- Material:  
Body and cover: Polypropylene Homopolymer
- Diaphragm: TPE (Thermoplastic Elastomer)

- ضغط التشغيل الموصى به: 0.8 – 2.5 بار.
- مقاس المدخل: 1/4 بوصة حربة تثبيت النقاط..
- المرشح: 150 ثقب.
- المواد: الجسم والغطاء: بولي بروبيلين هوموبوليمر الغشاء الحاجز: لدائن حرارية.

### Installation:

Use 2 mm punch tool

### التركيب:

إستخدام أداة مناسبة للتثقيب بقطر 2 ملم.

### Application:

- Watering plants in containers
- Home gardens
- Landscapes

### الإستخدامات:

- ري النباتات المزروعة في حاويات.
- حدائق المنازل..
- المساحات الخضراء.

### Laboratory conducted tests (Flow rate data)

### الإختبارات المعملية التي اجريت عليها (بيانات معدل التدفق)

Coefficient of variation of flow rate Cv%		7%			
Color	Flow rate	Pressure (bar)			
		0.8	1	2	2.5
Black	2 lph	1.9	2.1	3.1	3.5
Blue	4 lph	3.7	4.1	5.7	6.4
Brown	8 lph	7.2	8	11	12.2
Green	16 lph	15.2	16.3	20.7	22.8





## Turbo / PC

- Turbulent flow on-line drippers
- Outstanding PC drippers
- Constant water flow rates over a wide pressure range

## Features

- Dripper can be opened to facilitate easy cleaning.
- Manufactured from virgin plastic for stable performance.
- Silicone rubber diaphragm ensures consistent performance for longer periods.
- Narrow cross-shaped inlet acts as a filter.
- Optional anti-bug cap prevents intrusion of insects.
- Self-cleaning design ensures flushing at all times during operation.
- Wide operating pressure compensating range allows longer length of laterals.

## Specifications

- Available in flow rates 4 & 8 LPH
- Recommended operating pressure: 0.8-2.5 bar
- Inlet size: 1/4 inch barb
- Outlet side: 1/8 inch barb
- Filter requirement: 150 mesh
- Material:  
Body and cover; Polypropylene Homopolymer
- Diaphragm: TPE (Thermoplastic Elastomer)

## Installation

- Use 2 mm punch tool

## Application

- Watering plants in containers  
/Home gardens/ Landscapes.

## التربو / PC

منقطات التدفق الدوامي المتصلة بخط الأنابيب.

## الخصائص والمميزات:

- يمكن فتح المنقط مما يسهل عملية التنظيف. منقطات منظمة للضغوط - PC تتميز بمعدلات تدفق ثابتة علي نطاق ضغط واسعة.
- مصنوعة من البلاستيك النقي مما يؤدي إلي استقرار الأداء.
- غشاء السيليكون المطاط يضمن ثبات الأداء لفترات أطول.
- تعمل المداخل الضيقة صليبية الشكل بمثابة فلتر / مرشح.
- التصميم الذاتي التنظيف يضمن خلو مسارات التنقيط من الشوائب في جميع الأوقات أثناء التشغيل.
- نطاق تعويض الضغط التشغيلي الواسع يسمح بزيادة أطوال الفروع الجانبية لمسارات الأنابيب.

## التركيب:

إستخدام أداة مناسبة للتنقيب بقطر 2 ملم.

## الإستخدامات:

- ري النباتات المزروعة في حاويات.
- حدائق المنازل..
- المساحات الخضراء.

## المواصفات:

- متوفرة بمعدلات تدفق 4 و 8 لتر في الساعة.
- ضغط التشغيل الموصي به: 0.8 - 2.5 بار.
- مقياس المدخل: 1/4 بوصة حربة تثبيت النقاط..
- مقياس جانب المنفذ: 1/8 بوصة
- المرشح: 150 ثقب.
- المواد: الجسم والغطاء: بولي بروبيلين هوموبوليمر  
الغشاء الحاجز: لدائن حرارية.



Laboratory conducted tests  
(Flow rate data)

الإختبارات المعملية التي اجريت عليها  
(بيانات معدل التدفق)

Color	Color	Flow rate (L/H)	Pressure (bar)					
			0.8	1	1.5	2	2.5	3
NODPL04	Red	4 L/H	3.8	4	4.1	4.15	4.2	4.3
NODPL08	Yellow	8 L/H	7.7	7.8	7.9	8	8.1	8.1

\*Recommended operating pressure ranges from: 0.8 to 3 bar.



# NOTES

---

A series of horizontal dashed lines for writing notes.



# NOTES

---

A series of horizontal dashed lines for writing notes.